

# AMERICAN MOTORS PARTS CATALOG

## GROUP 3 ELECTRICAL - INSTRUMENTS

DESCRIPTION	GROUP AND FIGURE NO.	GROUP NO.
ALTERNATOR .....	.....	3.005
AMMETER, Alternator .....	.....	3.600
ARM, Directional Signal Switch .....	3-10 .....	3.321
ARMATURE, Generator .....	3-2 .....	3.005
ARMATURE, Starting Motor .....	3-3, 3-4 .....	3.020
BAR, Alternator Attaching .....	.....	3.014
BAR, Generator Attaching .....	.....	3.014
BAR, Rectifier Attaching .....	.....	3.014
BATTERY .....	3-1 .....	3.080
BELT, Fan and Generator .....	2-1, 2-2 .....	3.008
BLOCK, Junction .....	3-1 .....	3.213
BODY, Headlamp .....	3-7A, 3-9 .....	3.248
BODY, Parking and Front Directional Signal Lamp .....	3-10A, 3-10B, 3-10C .....	3.292
BODY, Tail, Stop and Rear Directional Signal Lamp .....	3-10D, 3-10E, 3-10F .....	3.303
BRACKET, Alternator Attaching .....	.....	3.014
BOX, Battery .....	3-7B, 3-7C, 3-7D, 3-7E .....	3.082
BRACE, Battery Box .....	3-7B, 3-7C, 3-7D, 3-7E .....	3.082
BRACKET, Back-Up Lamp Switch .....	.....	3.319
BRACKET, Generator Attaching .....	.....	3.014
BRACKET, Ignition Coil .....	.....	3.060
BRACKET, Rectifier Attaching .....	.....	3.014
BRACKET, Starting Motor Switch .....	.....	3.022
BREAKER, Circuit .....	.....	3.154
BRUSH, Generator .....	3-2 .....	3.005
BRUSH, Starting Motor .....	3-3, 3-4 .....	3.020
BULB .....	Refer Group 3 .....	3.215
BULB, Headlamp .....	3-7A, 3-9 .....	3.280
BULB, License Plate Lamp .....	3-10i, 3-10J, 3-11 .....	3.339
BULB, Parking and Front Directional Signal Lamp .....	3-10A, 3-10B, 3-10C .....	3.292
BULB, Tail, Stop and Rear Directional Signal Lamp .....	3-10D, 3-10E, 3-10F .....	3.315
BUSHING, Starting Motor Switch .....	.....	3.022
BUTTON, Horn .....	3-12, 0-15 .....	3.400
CABLE, Battery Ground .....	3-1 .....	3.196
CABLE, Battery to Starter Solenoid .....	3-1 .....	3.200
CABLE, Speedometer .....	Refer Page 57 .....	3.570
CABLE, Starting Switch to Starting Motor .....	.....	3.203
CAM, Directional Signal Switch .....	3-10 .....	3.321
CAP, Distributor .....	3-1, 3-5, 3-6, 3-7, 0-11, 0-12 .....	3.032
CLAMP, Battery Hold Down .....	3-7B, 3-7C, 3-7D, 3-7E .....	3.084
CLAMP, Distributor .....	.....	3.039
CLIP, Ignition Wire .....	.....	3.230
CLOCK .....	0-14, 0-15 .....	3.360
COIL, Ignition .....	3-1, 0-11 .....	3.056
COIL, Starting Motor .....	3-3, 3-4 .....	3.020
COIL SET, Generator .....	3-2 .....	3.005
CONDENSER, Distributor .....	3-5, 3-6, 3-7 .....	3.033
CONTACT SET, Ignition .....	3-5, 3-6, 3-7 .....	3.031
CONTROL, Distributor Vacuum .....	3-1, 3-6, 3-7, 0-11, 4-3, 4-4, 4-5 .....	3.046
CORE, Speedometer Cable .....	Refer Page 57 .....	3.575
COVER, Clock Opening (Less Clock) .....	.....	3.383
CYLINDER, Ignition Switch Lock .....	3-8 .....	3.135
DISTRIBUTOR .....	3-1, 3-5, 3-6, 3-7, 0-11, 0-12 .....	3.030
DOOR, Headlamp .....	3-7A .....	3.252
ELBOW, Stop and Tail Lamp Switch .....	8-6 .....	3.333
EXTENSION, Tail, Stop and Rear Directional Signal Lamp ....	3-10G, 3-10H .....	3.303

# AMERICAN MOTORS PARTS CATALOG

DESCRIPTION	GROUP AND FIGURE NO.	GROUP NO.
FAN, Generator .....	3-2 .....	3.010
FLASHER, Directional Signal .....	.....	3.330
FUSE, Lighting Switch .....	.....	3.152
GASKET, Back-Up Lamp Lens .....	3-10H .....	3.317
GASKET, Instrument Cluster Lens .....	.....	3.520
GASKET, Parking and Front Directional Signal Lamp .....	3-10A, 3-10B, 3-10C .....	3.292
GASKET, Speedometer Cable .....	.....	3.580
GASKET, Tail, Stop and Rear Directional Signal Lamp .....	3-10D, 3-10E, 3-10F .....	3.305
GAUGE, Gasoline .....	3-14, 3-15, 3-16, 4-6 .....	3.615
GAUGE, Oil Pressure .....	.....	3.605
GAUGE, Water Temperature .....	3-14, 3-15, 3-16 .....	3.610
GEAR, Distributor .....	3-1, 3-6, 3-7 .....	3.042
GEAR, Speedometer Driven .....	Refer Page 59 .....	3.590
GENERATOR .....	3-2 .....	3.005
GROMMET, Wiring .....	.....	3.166
HARNESS, Body Wire .....	.....	3.163
HARNESS, Chassis Wiring .....	3-1 .....	3.165
HARNESS, Instrument Cluster .....	3-14, 3-15, 3-16 .....	3.635
HARNESS, Overdrive .....	.....	3.210
HEADLAMP .....	3-7A, 3-9, Refer Group 0 .....	3.245
HORN, Dual .....	.....	3.105
HOUSING, Headlamp Dimmer Switch .....	.....	3.159
HOUSING, Instrument Cluster .....	3-14, 3-15, 3-16 .....	3.505
HOUSING, Parking and Front Directional Signal Lamp .....	3-10C, 2-5 .....	3.292
INSULATOR, Horn Blowing Ring Retainer .....	3-13 .....	3.406
KNOB, Lighting Switch .....	0-14, 0-15 .....	3.150
LAMP, Clock .....	.....	3.378
LAMP, Courtesy .....	.....	3.349
LAMP, Dome .....	.....	3.346
LAMP, Glove Box .....	.....	3.378
LAMP, License .....	3-10i, 3-10J, 3-11 .....	3.335
LAMP, Parking and Front Directional Signal .....	3-10A, 3-10B, 3-10C, Refer Group 0 .....	3.292
LAMP, Tail, Stop and Rear Directional Signal .....	3-10D, 3-10E, 3-10F, Refer Group 0 .....	3.300
LENS, Back-Up Lamp .....	3-10H, 0-6, 0-8, 0-10 .....	3.317
LENS, Clock .....	.....	3.369
LENS, Instrument Cluster .....	3-14, 3-15, 3-16, 0-15 .....	3.515
LENS, License Plate Lamp .....	3-10i, 3-10J, 3-11 .....	3.339
LENS, Parking and Front Directional Signal Lamp .....	3-10A, 3-10B, 3-10C, Refer Group 0 .....	3.292
LENS, Tail, Stop and Rear Directional Signal Lamp .....	3-10D, 3-10E, 3-10F, Refer Group 0 .....	3.306
LEVER, Directional Signal Switch .....	3-10, 0-15 .....	3.324
LIGHTER, Cigar .....	0-14, 0-15 .....	3.352
MASK, Instrument Cluster .....	3-15, 3-16 .....	3.515
MOTOR, Starting .....	3-1, 3-3, 0-11, 0-12 .....	3.020
PLATE, Clock Opening Cover (Less Clock) .....	.....	3.383
PLATE, Directional Signal Switch Mounting .....	.....	3.321
PLUG, Spark .....	3-1, 0-11, 0-12, 0-13 .....	3.001
RECTIFIER .....	.....	3.005
REFLECTOR, Tail, Stop and Rear Directional Signal Lamp ..	3-10D, 3-10E, 3-10F, 3-10G .....	3.303
REGULATOR, Generator Voltage .....	.....	3.012
REGULATOR, Instrument Cluster Voltage .....	3-14, 3-15, 3-16 .....	3.622
RELAY, Horn .....	.....	3.125
RESISTOR, Ignition .....	3-1 .....	3.065
RETAINER, Instrument Cluster Lens .....	3-14, 3-15 .....	3.525
RING, Headlamp Bulb Retaining .....	3-7A, 3-9 .....	3.275
RING, Horn Blowing .....	3-13, 0-14 .....	3.406
ROD, Battery Hold Down Strap ..	3-7B, 3-7C, 3-7D, 3-7E .....	3.095
ROD, Starting Motor Neutral Safety Switch .....	7-3 .....	3.022

# AMERICAN MOTORS PARTS CATALOG

DESCRIPTION	GROUP AND FIGURE NO.	GROUP NO.
ROTOR, Distributor .....	3-5, 3-6, 3-7 .....	3.035
SCREW, Headlamp Adjusting .....	3-7A, 3-9 .....	3.268
SEPARATOR, Ignition Wire .....	.....	3.230
SHAFT, Distributor Main .....	3-5, 3-6, 3-7 .....	3.030
SHELL, Headlamp Adjusting .....	3-7A, 3-9 .....	3.265
SOCKET, License Plate Lamp .....	3-10i, 3-10J, 3-11 .....	3.341
SPEEDOMETER .....	3-14, 3-15, 3-16 .....	3.550
SPRING, Headlamp Adjusting .....	3-7A, 3-9 .....	3.272
SPRING, Horn Blowing Ring Contact .....	3-13 .....	3.406
SPRING, Horn Button .....	3-12 .....	3.416
STRAP, Alternator Attaching .....	.....	3.014
STRAP, Generator Attaching .....	.....	3.014
STRAP, Rectifier Attaching .....	.....	3.014
SUPPORT, Ignition Coil .....	0-11 .....	3.058
SUPPORT, Ignition Wire .....	.....	3.226
SWITCH, Back-Up Lamp .....	7-4 .....	3.319
SWITCH, Directional Signal .....	3-10 .....	3.321
SWITCH, Headlamp Dimmer .....	0-14 .....	3.158
SWITCH, Ignition .....	3-1, 3-8, 0-15 .....	3.130
SWITCH, Lighting .....	.....	3.145
SWITCH, Solenoid .....	3-1, 3-3, 3-4, 0-12 .....	3.020
SWITCH, Starting Motor .....	7-3, 7-4 .....	3.022
SWITCH, Stop and Tail Lamp .....	8-6, 8-7 .....	3.333
TRUNNION, Starting Motor Switch .....	7-3 .....	3.022
TUBE, Distributor Vacuum Control .....	4-3, 4-4, 4-5 .....	3.048
WIRE, Back-Up Lamp .....	3-10H, 7-4 .....	3.318
WIRE, Clock Lamp .....	.....	3.378
WIRE, Distributor to Coil High Tension .....	3-1, 0-11 .....	3.232
WIRE, Distributor to Coil Low Tension .....	3-1 .....	3.235
WIRE, Glove Box Lamp .....	.....	3.378
WIRE, Headlamp .....	3-7A, 3-9 .....	3.288
WIRE, Hood Ornament Lamp .....	.....	3.190
WIRE, Horn .....	.....	3.192
WIRE, Instrument Cluster .....	3-14, 3-15, 3-16 .....	3.635
WIRE, License Plate Lamp Socket .....	3-10i, 3-10J, 3-11 .....	3.341
WIRE, Overdrive .....	.....	3.210
WIRE, Parking and Front Directional Signal Lamp .....	3-10A, 3-10B, 3-10C .....	3.292
WIRE, Starting Motor Switch .....	7-4 .....	3.022
WIRE, Tail, Stop and Rear Directional Signal Lamp .....	3-10D, 3-10E, 3-10F .....	3.312
WIRE SET, Ignition .....	3-1, 0-11 .....	3.228

# AMERICAN MOTORS PARTS CATALOG

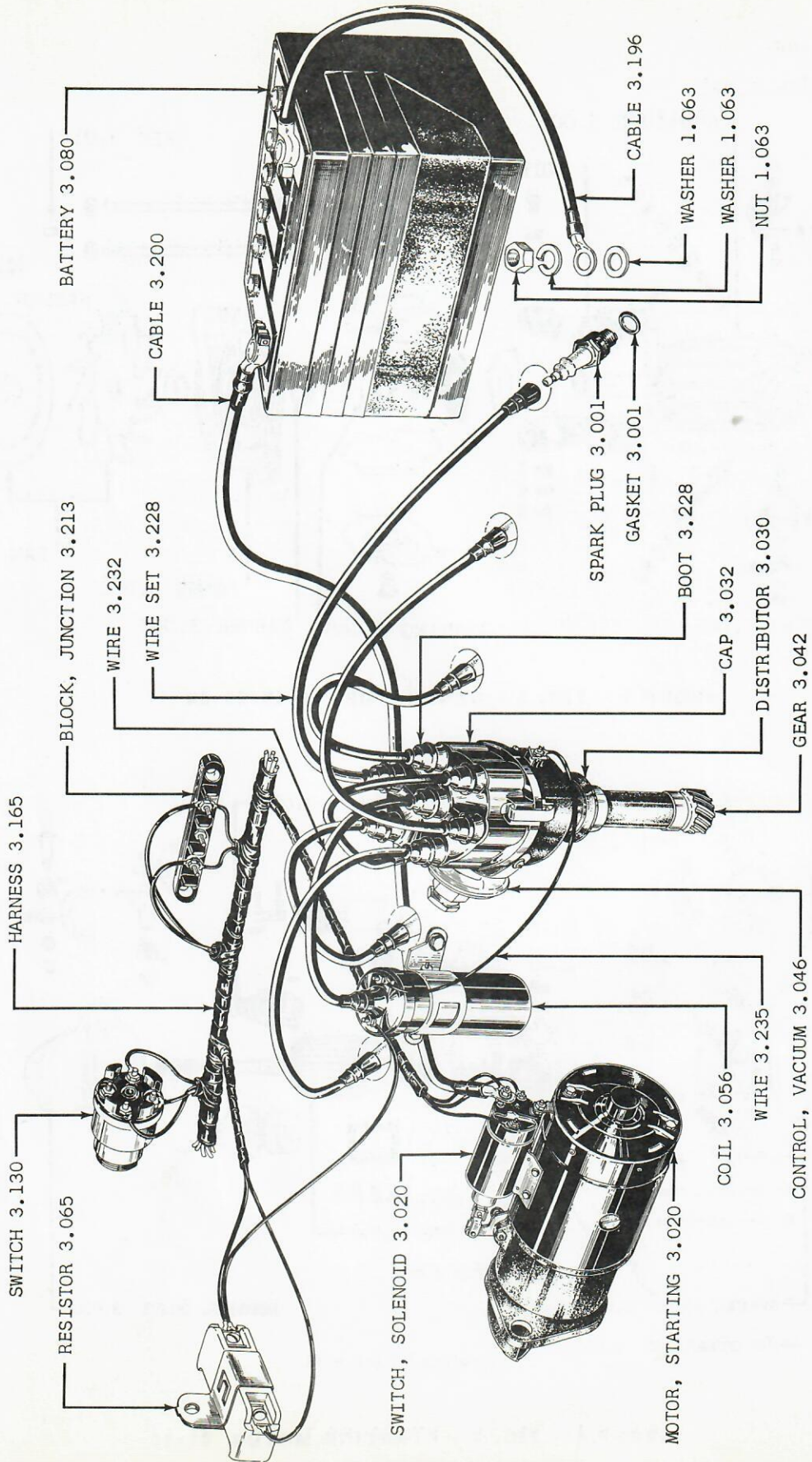

GROUP 3 - FIG. 1 - IGNITION WIRING 10

# AMERICAN MOTORS PARTS CATALOG

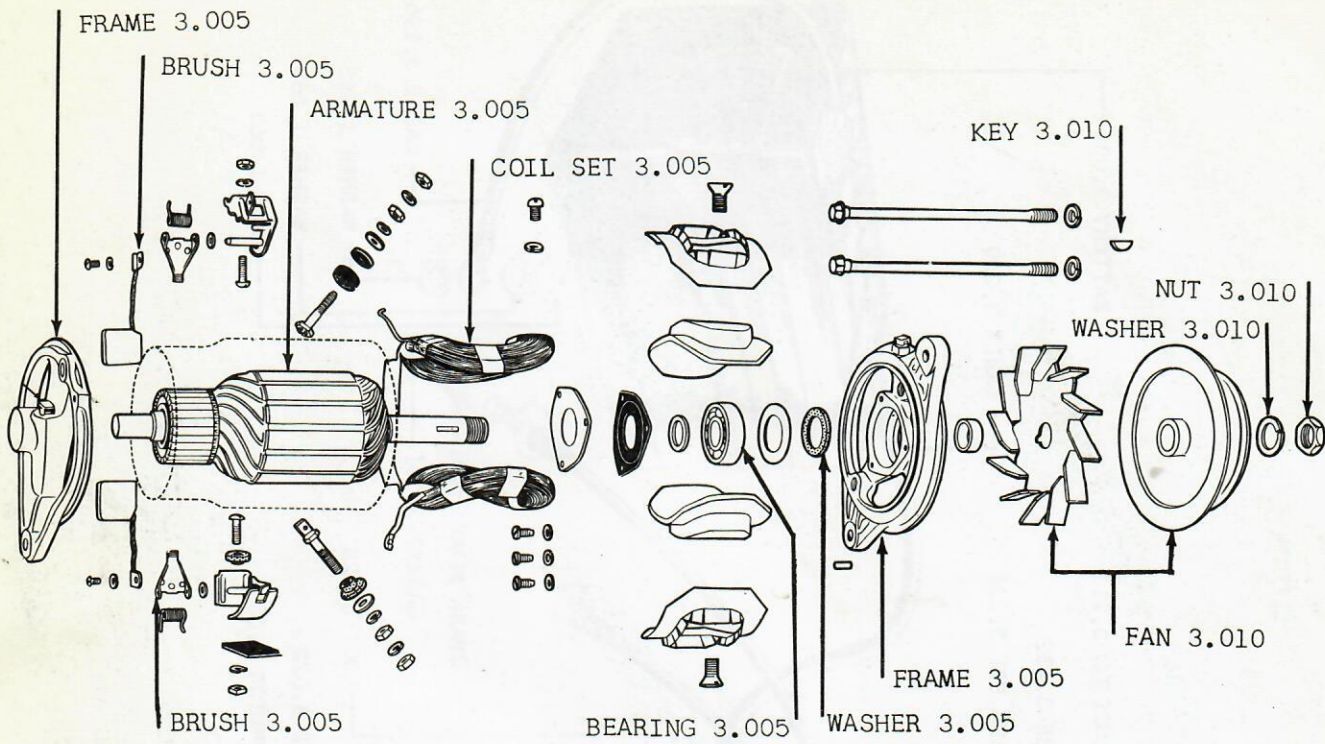

GROUP 3 - FIG. 2 - GENERATOR 01-10-20-80

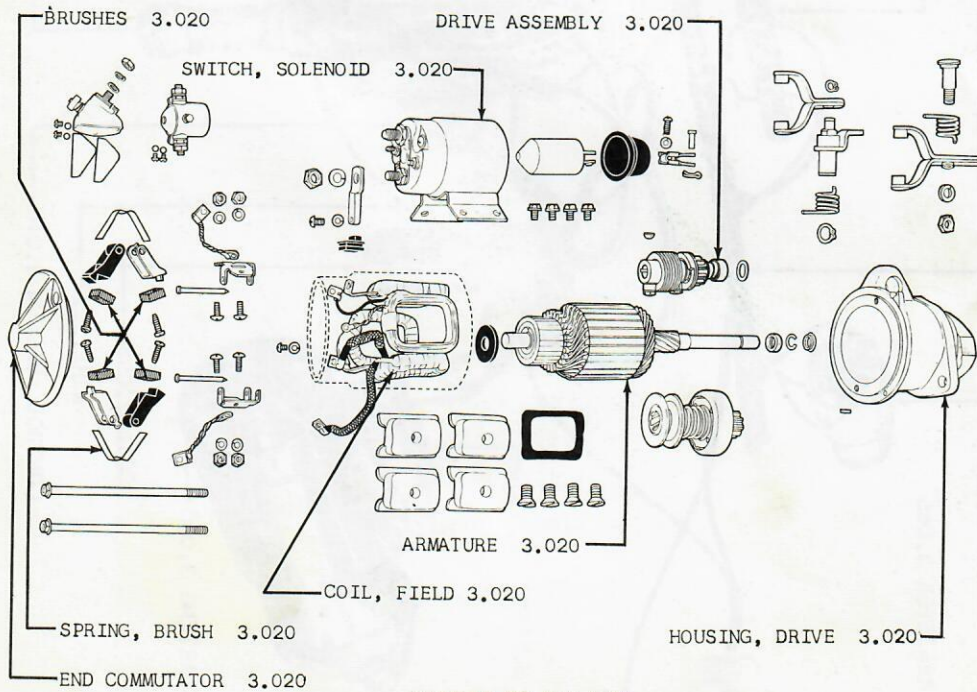

SIMILAR TO 314 5176

GROUP 3 - FIG. 3 - STARTING MOTOR 01-10

# AMERICAN MOTORS PARTS CATALOG

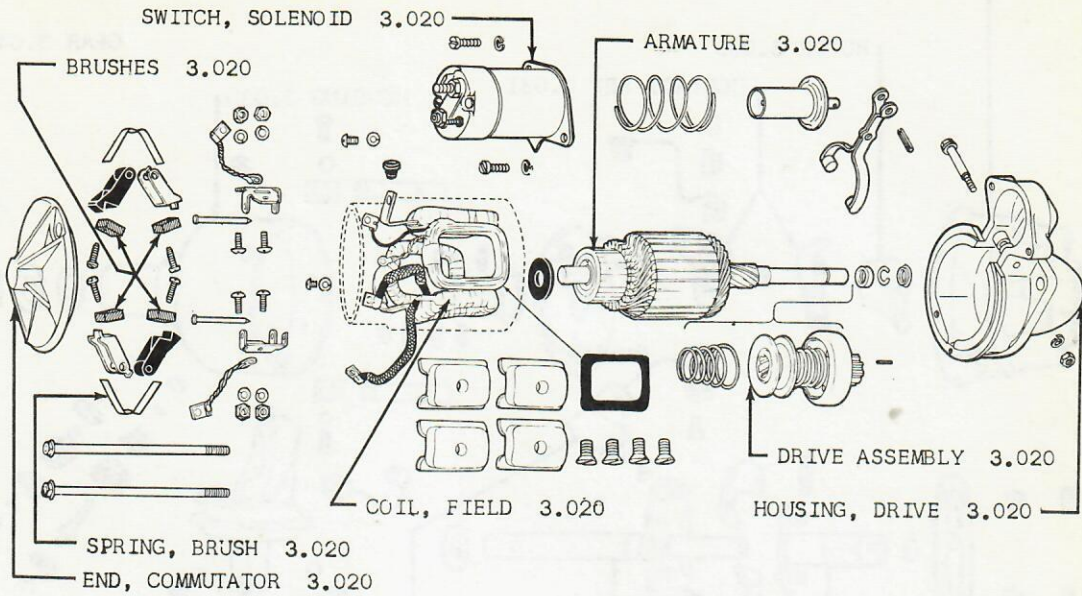

SIMILAR TO 315 6116-315 4786-315 5612

GROUP 3 - FIG. 4 - STARTING MOTOR 01-10-20-80

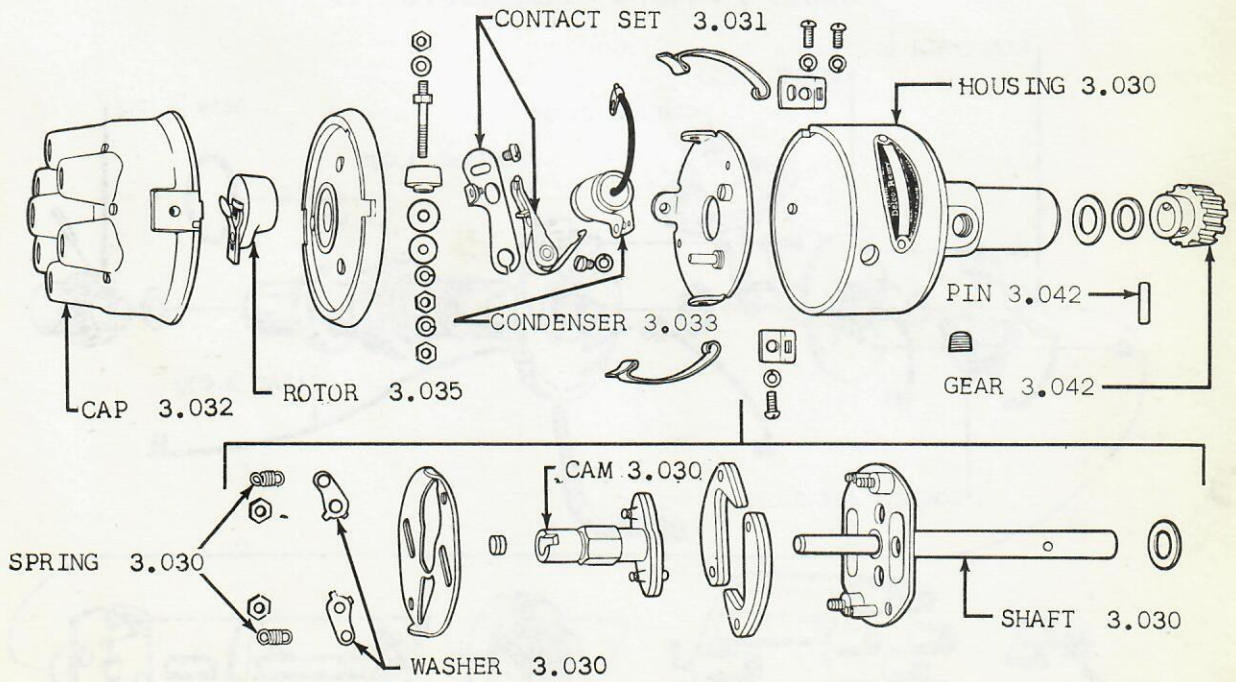

GROUP 3 - FIG. 5 - DISTRIBUTOR 01

# AMERICAN MOTORS PARTS CATALOG

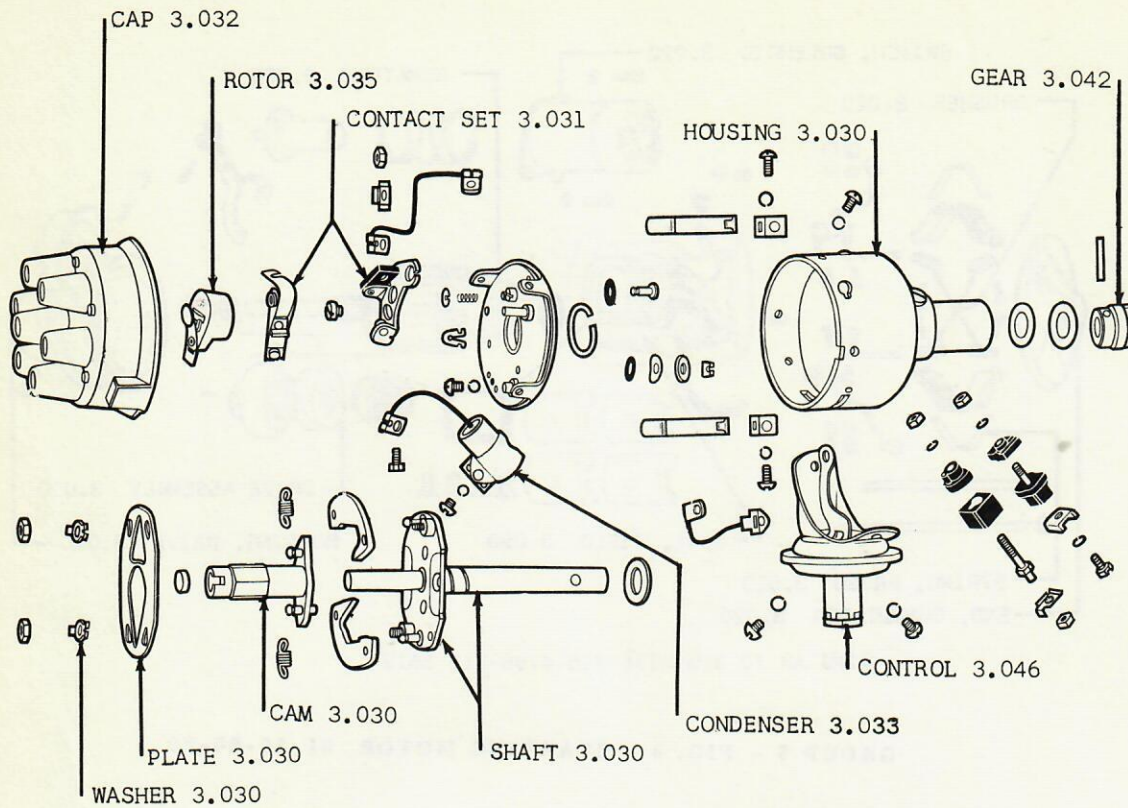

**GROUP 3 - FIG. 6 - DISTRIBUTOR 10**

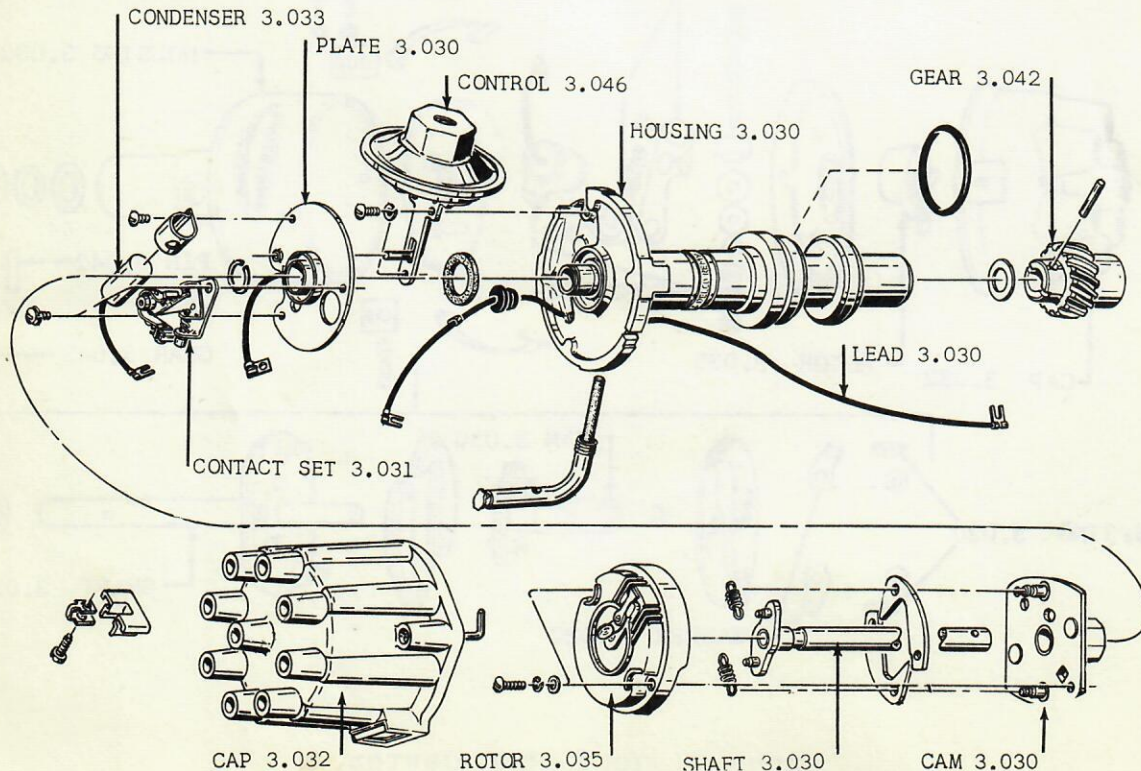

**GROUP 3 - FIG. 7 - DISTRIBUTOR 20-80**

# AMERICAN MOTORS PARTS CATALOG

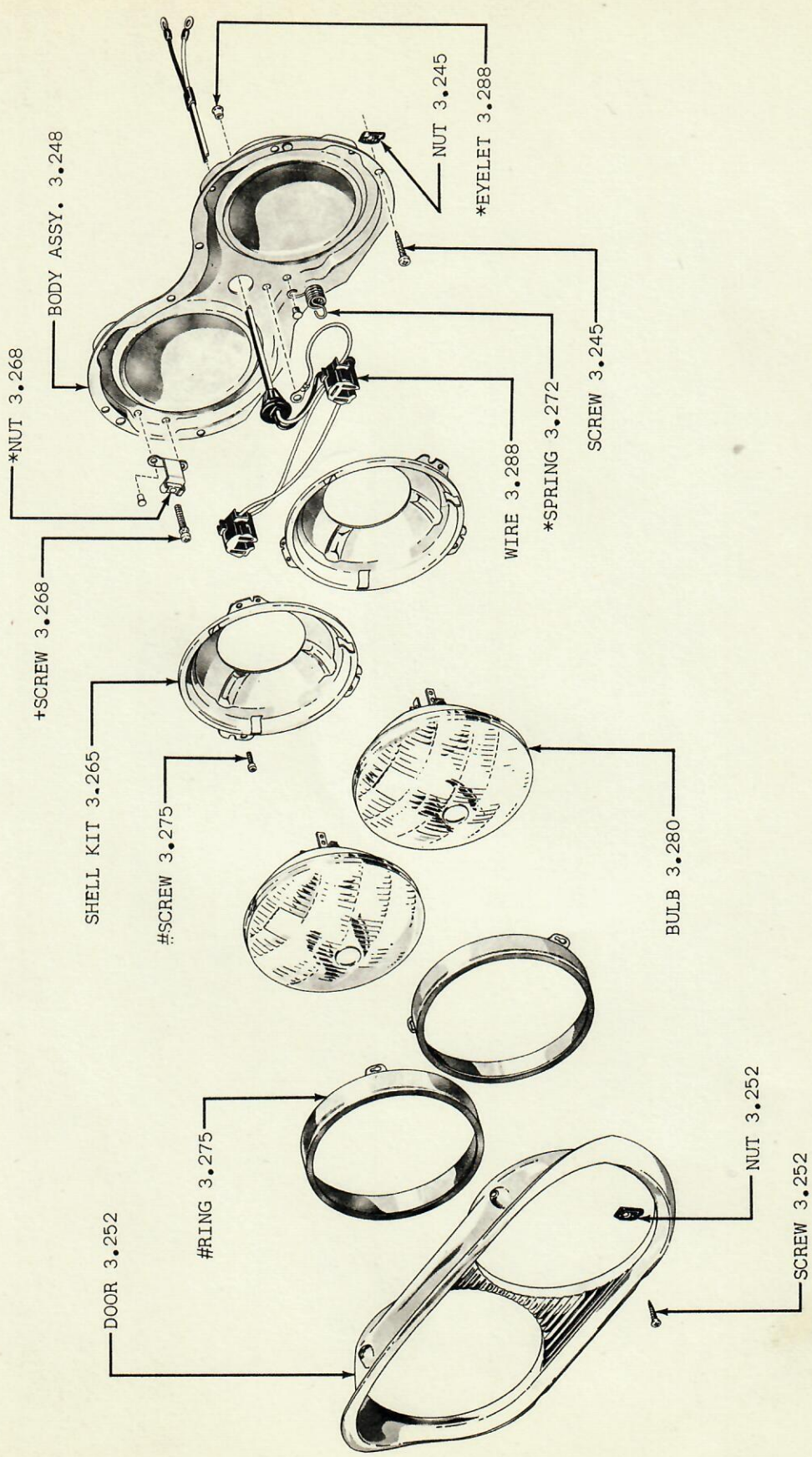

\* ALSO SERVICED AS PART OF BODY ASSY. 3.248  
 # ALSO SERVICED AS PART OF SHELL KIT 3.265  
 + ALSO SERVICED AS PART OF BODY ASSY. 3.248 AND SHELL KIT 3.265

GROUP 3 - FIG. 7A - DUAL HEADLAMP 10-20-80



# AMERICAN MOTORS PARTS CATALOG

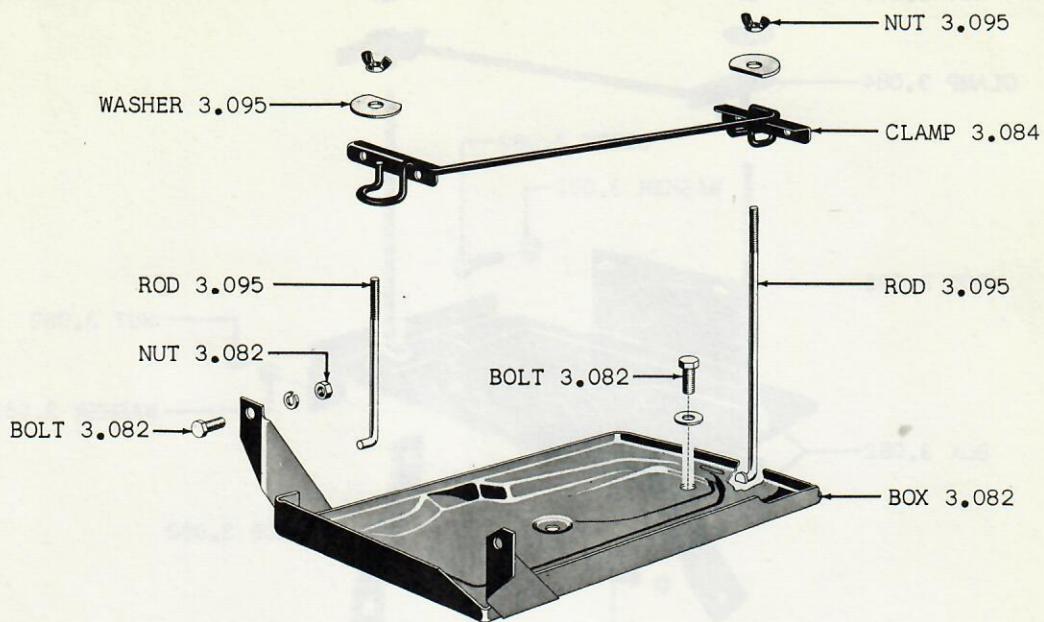

GROUP 3 - FIG. 7B - BATTERY BOX 01

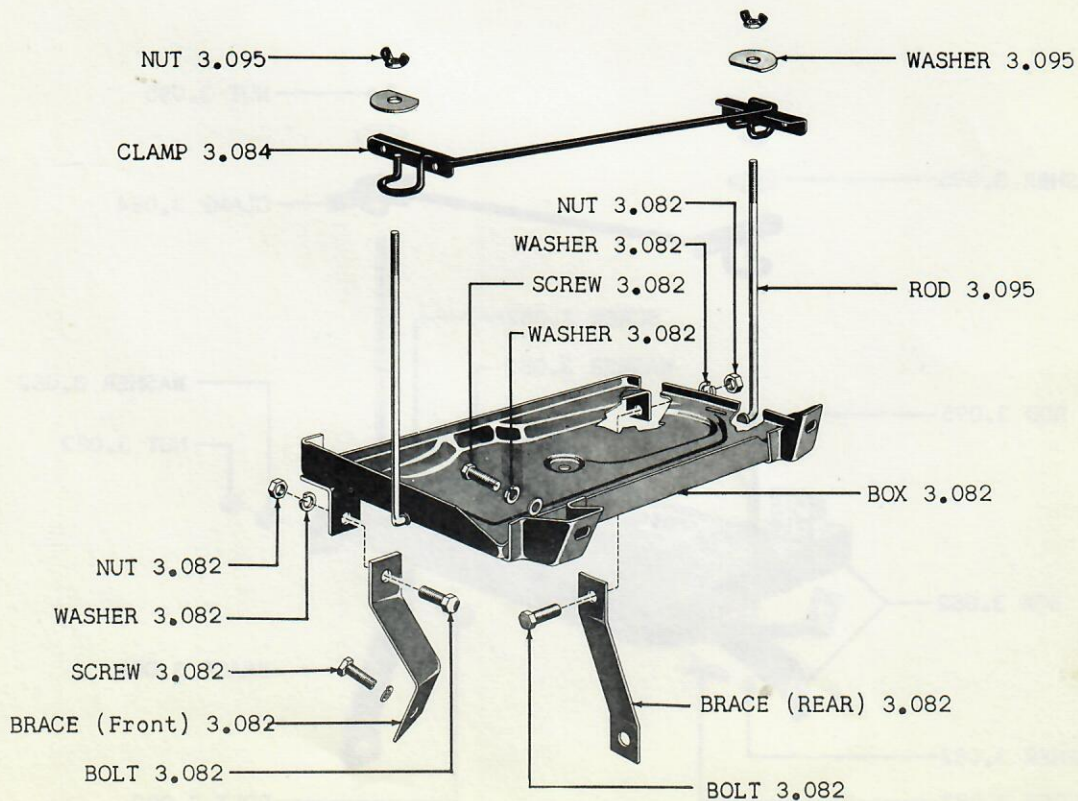

GROUP 3 - FIG. 7C - BATTERY BOX 10

# AMERICAN MOTORS PARTS CATALOG

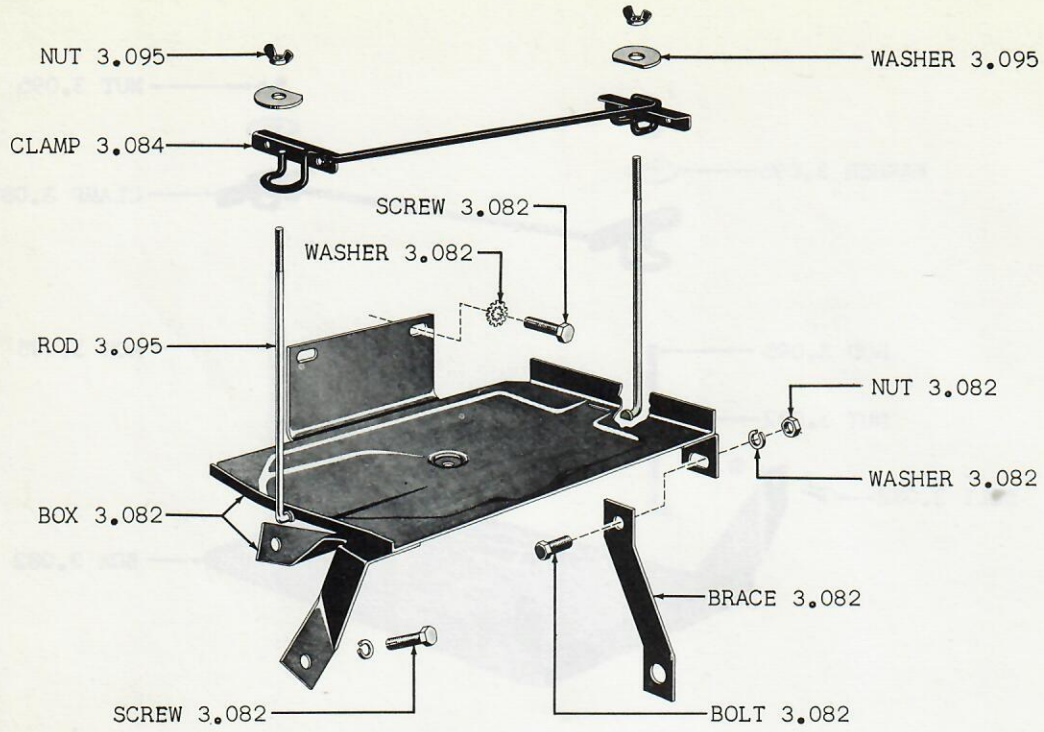

GROUP 3 - FIG. 7D - BATTERY BOX 20

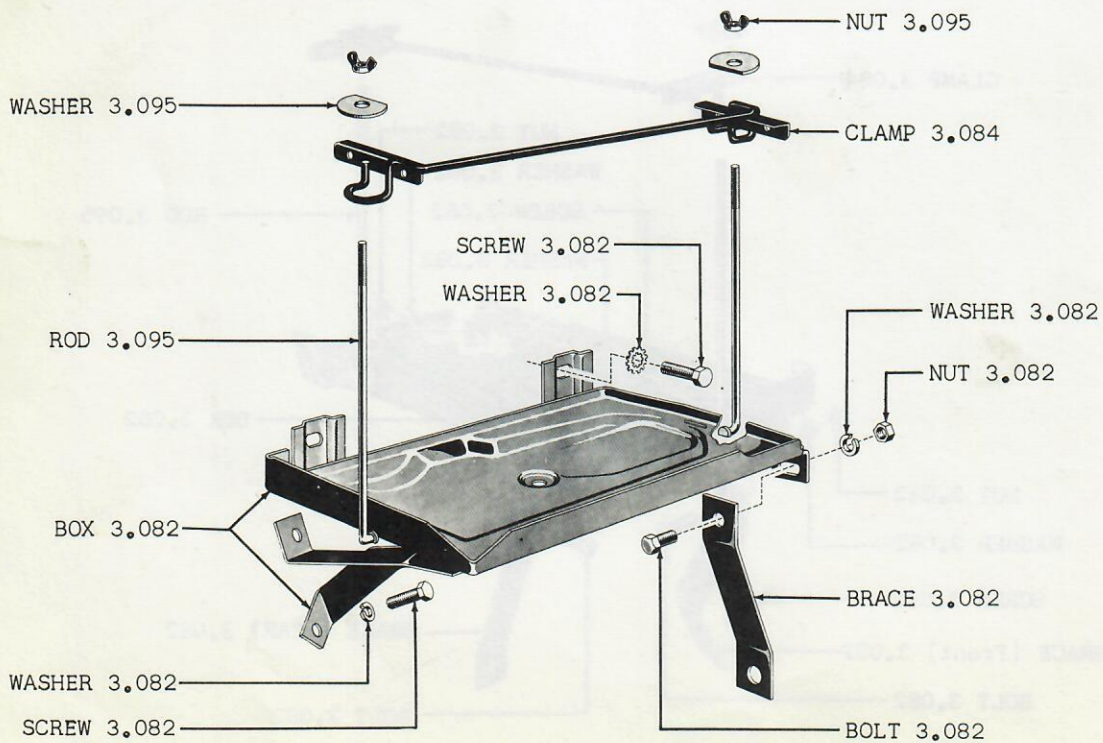

GROUP 3 - FIG. 7E - BATTERY BOX 80

# AMERICAN MOTORS PARTS CATALOG

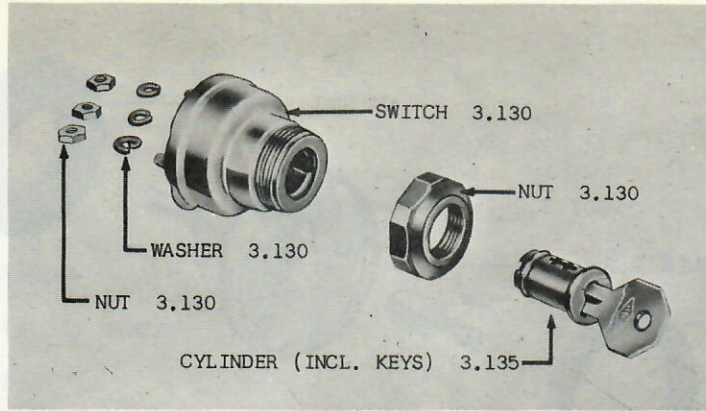

GROUP 3 - FIG. 8 - IGNITION SWITCH 01

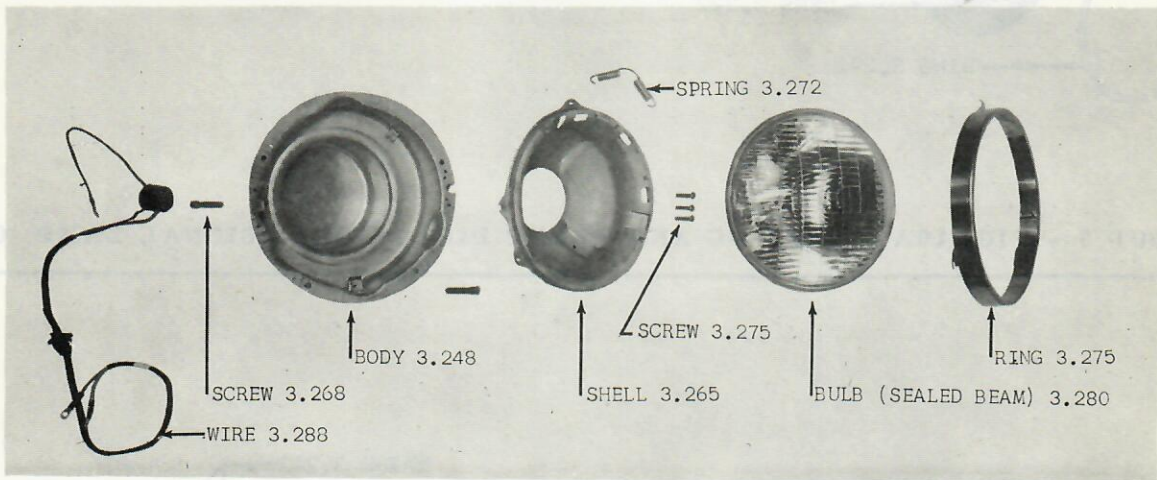

GROUP 3 - FIG. 9 - HEADLAMP 10-20 (DELUXE): 01

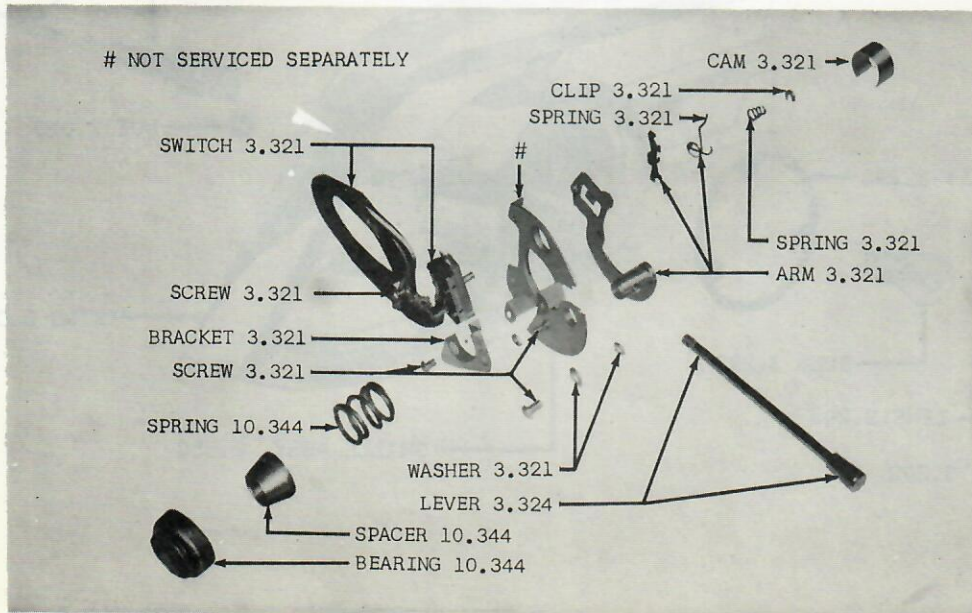

GROUP 3 - FIG. 10 - DIRECTIONAL SIGNAL ASSEMBLY 01-10-20-80

# AMERICAN MOTORS PARTS CATALOG

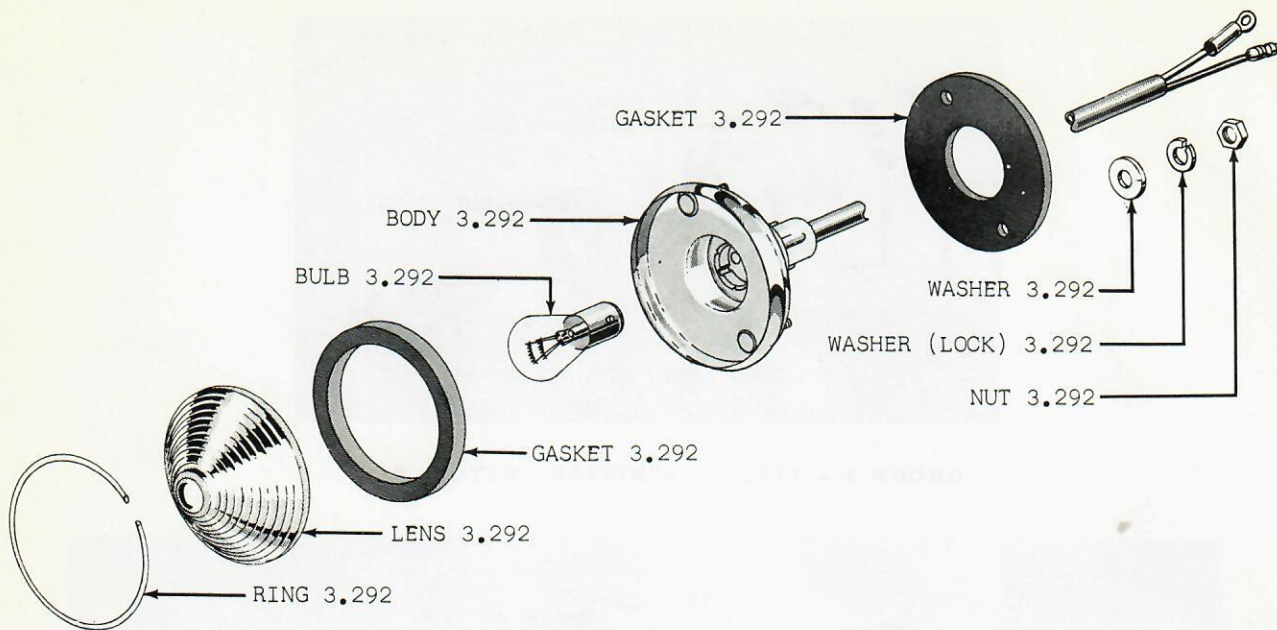

GROUP 3 - FIG. 10A - PARKING AND FRONT DIRECTIONAL SIGNAL LAMP 01

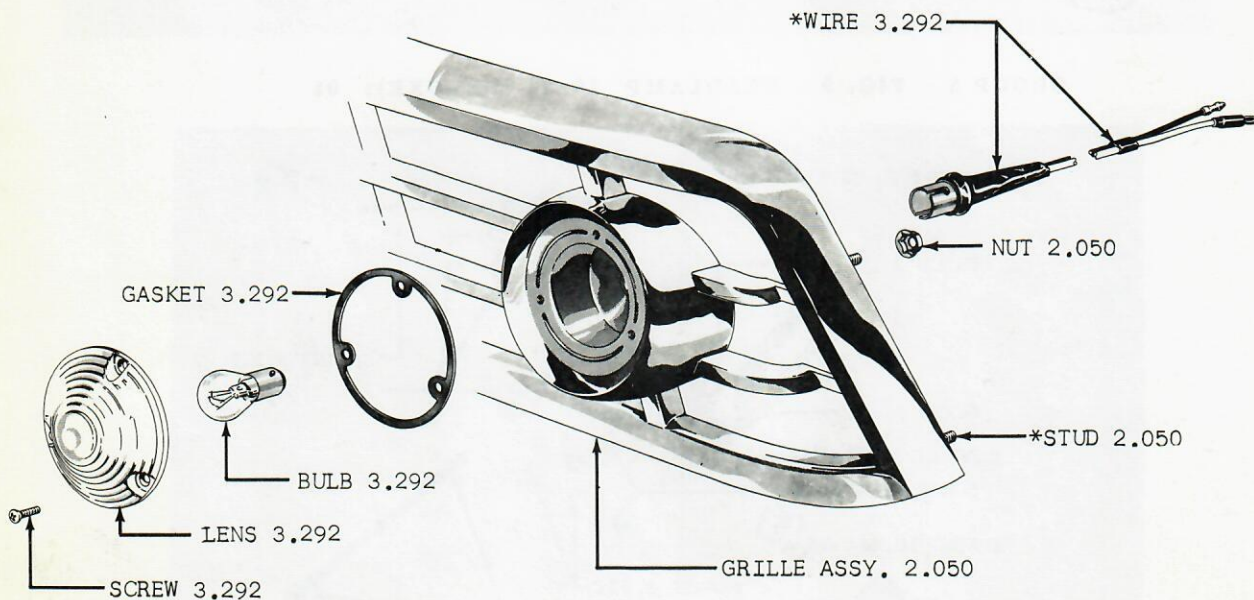

\* ALSO SERVICED AS PART OF GRILLE ASSY. 2.050

GROUP 3 - FIG. 10B - PARKING AND FRONT DIRECTIONAL SIGNAL LAMP 10-20

# AMERICAN MOTORS PARTS CATALOG

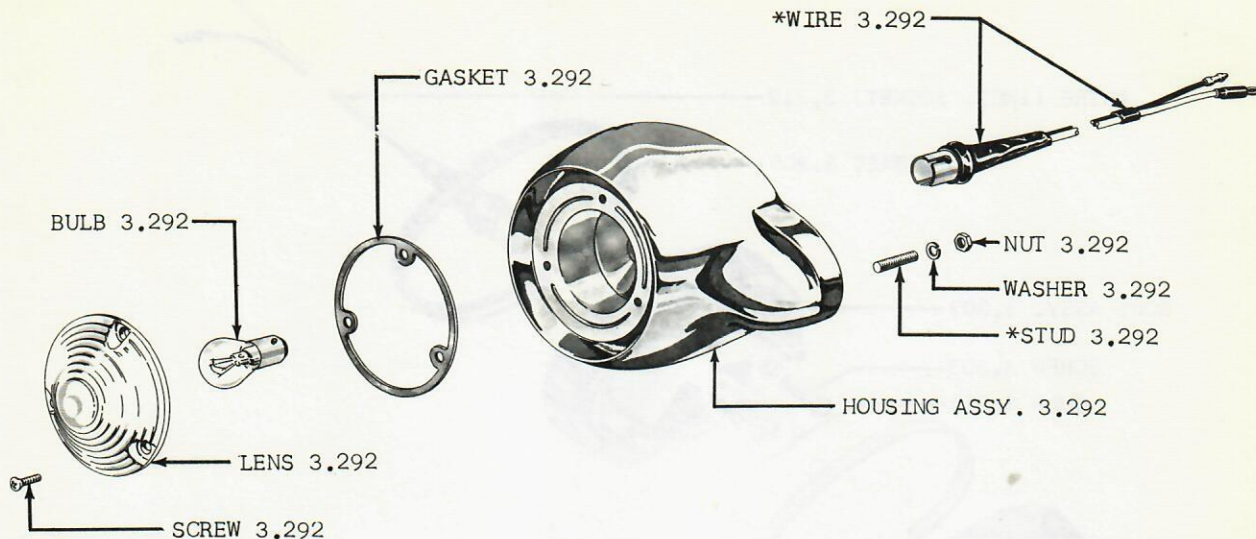

\* ALSO SERVICED AS PART OF HOUSING ASSY. 3.292

## GROUP 3 - FIG. 10C - PARKING AND FRONT DIRECTIONAL SIGNAL LAMP 80

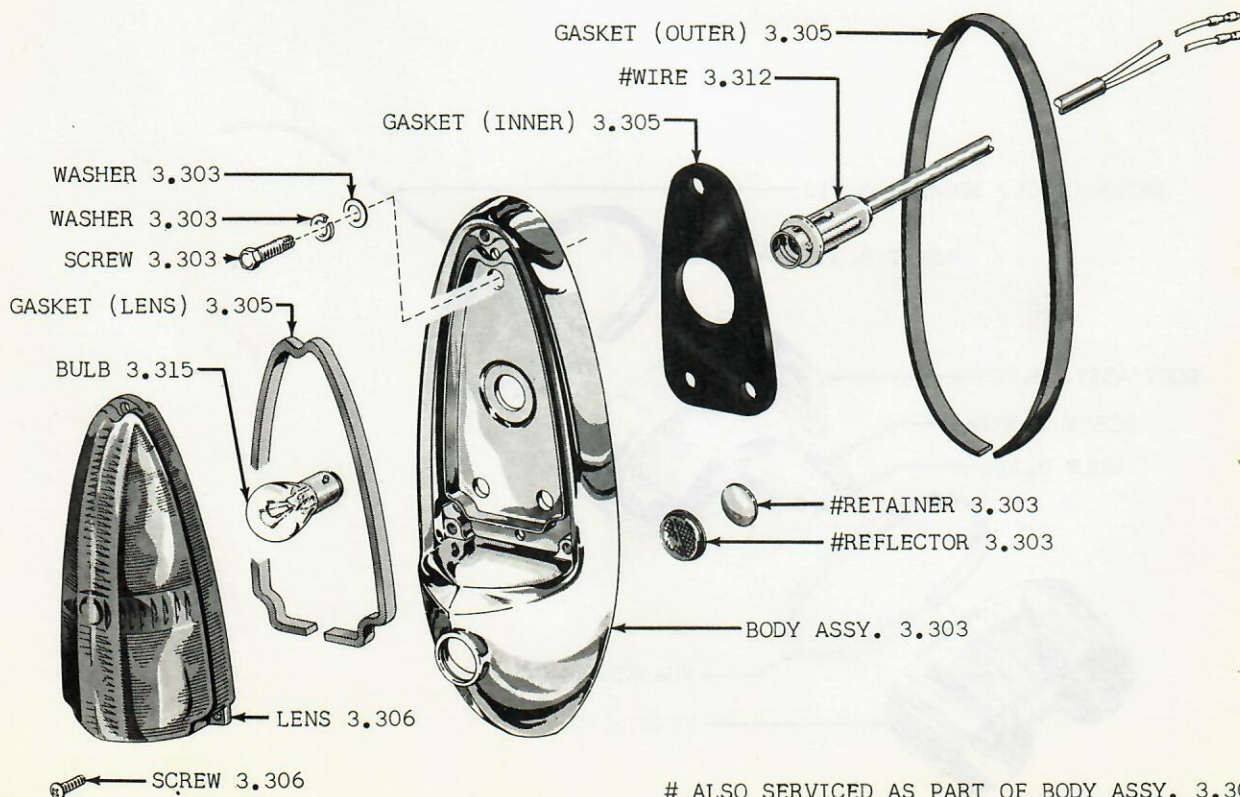

# ALSO SERVICED AS PART OF BODY ASSY. 3.303

## GROUP 3 - FIG. 10D - TAIL, STOP AND REAR DIRECTIONAL SIGNAL LAMP 01

# AMERICAN MOTORS PARTS CATALOG

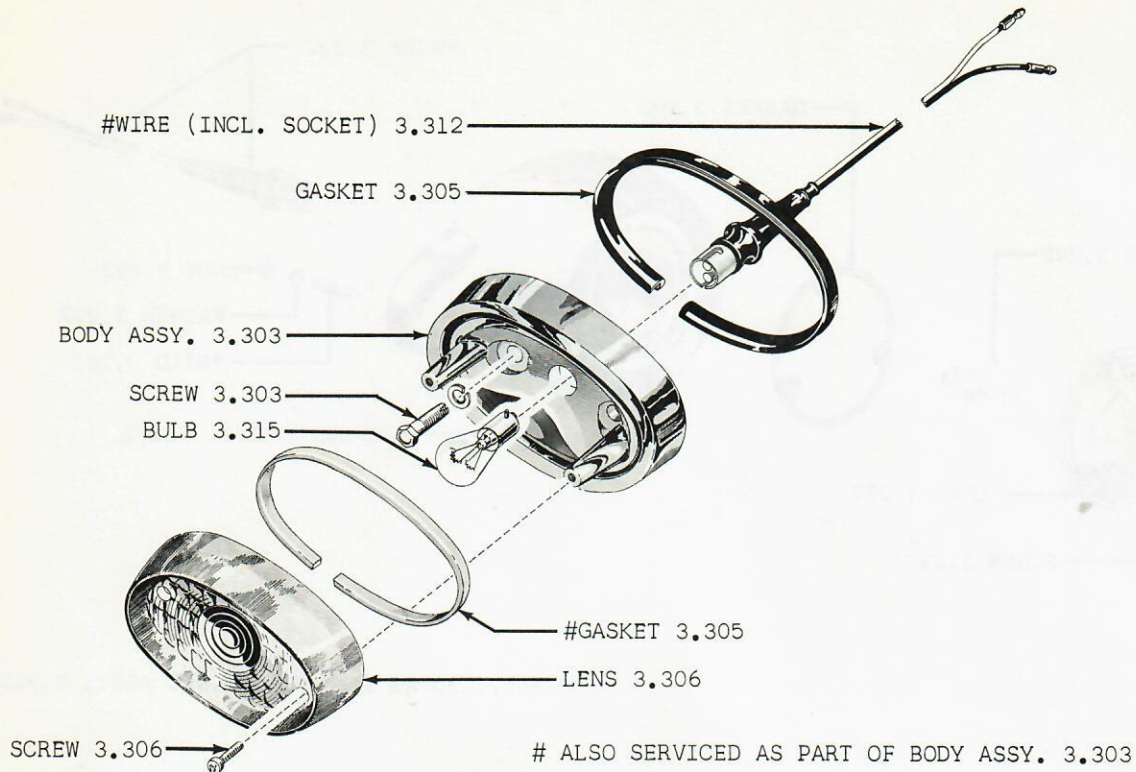

GROUP 3 - FIG. 10E - TAIL, STOP AND REAR DIRECTIONAL SIGNAL LAMP 10-20

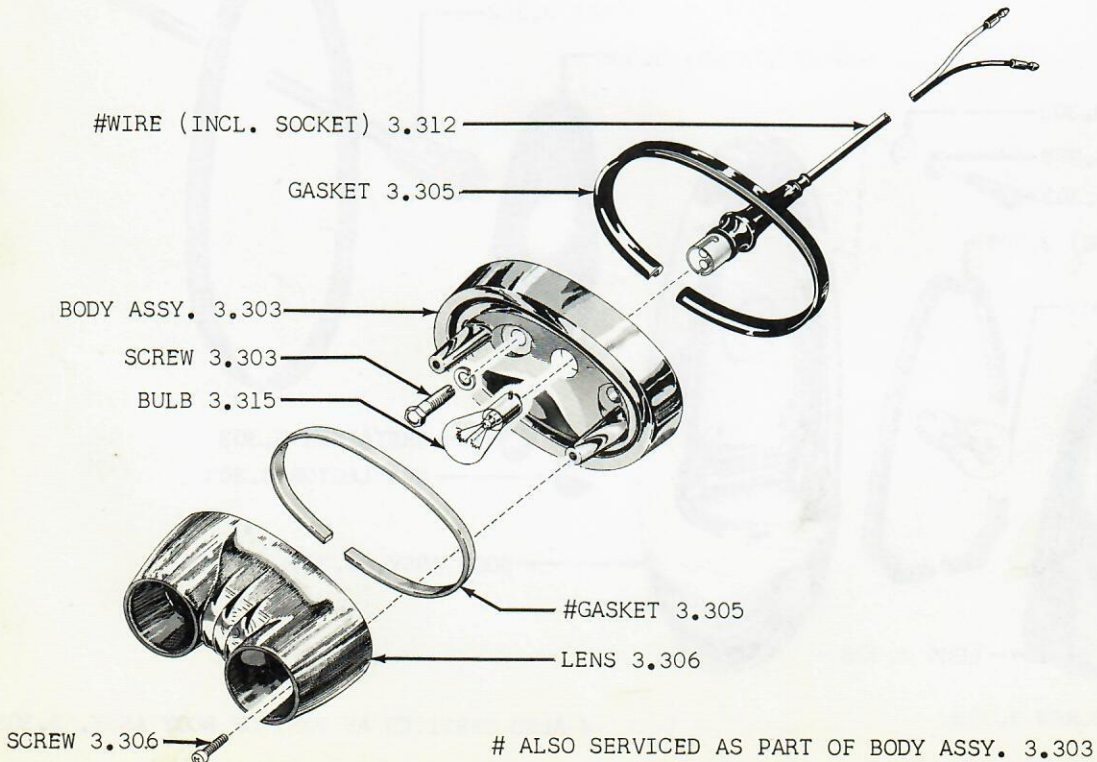

GROUP 3 - FIG. 10F - TAIL, STOP AND REAR DIRECTIONAL SIGNAL LAMP 80

# AMERICAN MOTORS PARTS CATALOG

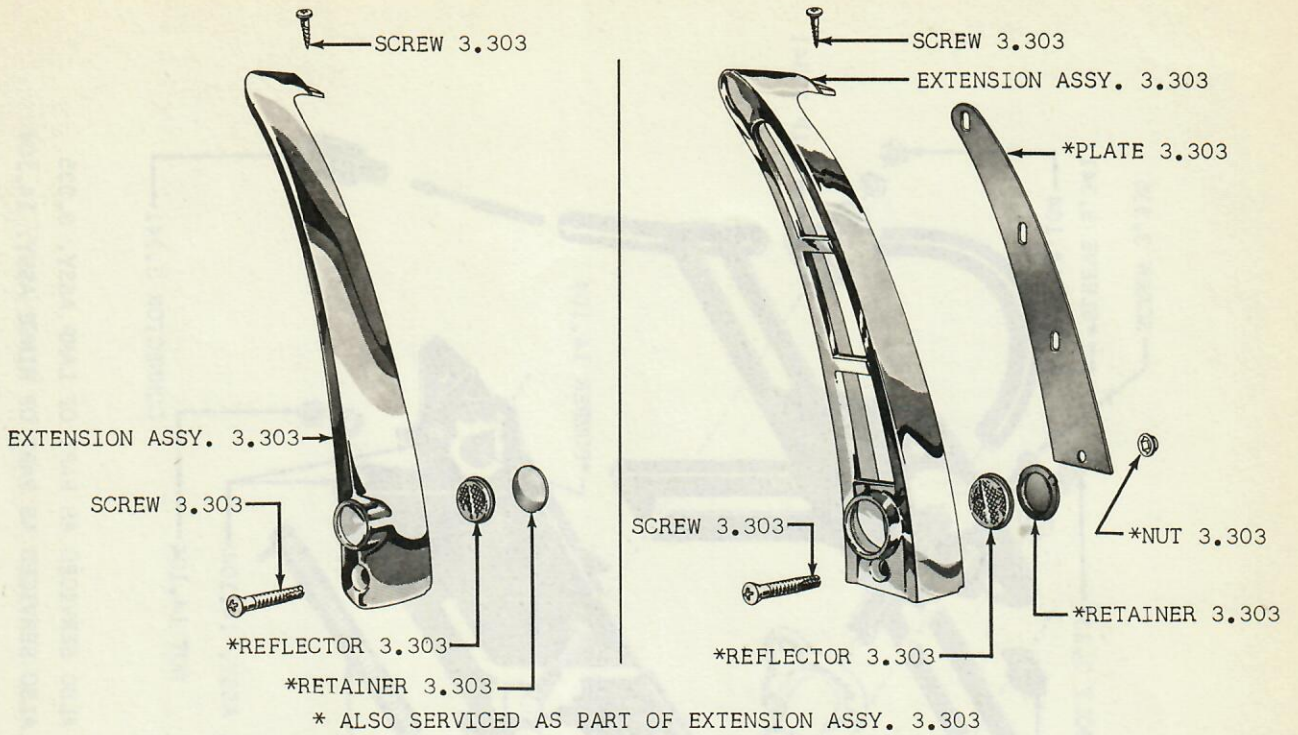

**59 10-20**

**59 80**

GROUP 3 - FIG. 10G - TAIL LAMP UPPER EXTENSION 10-20-80

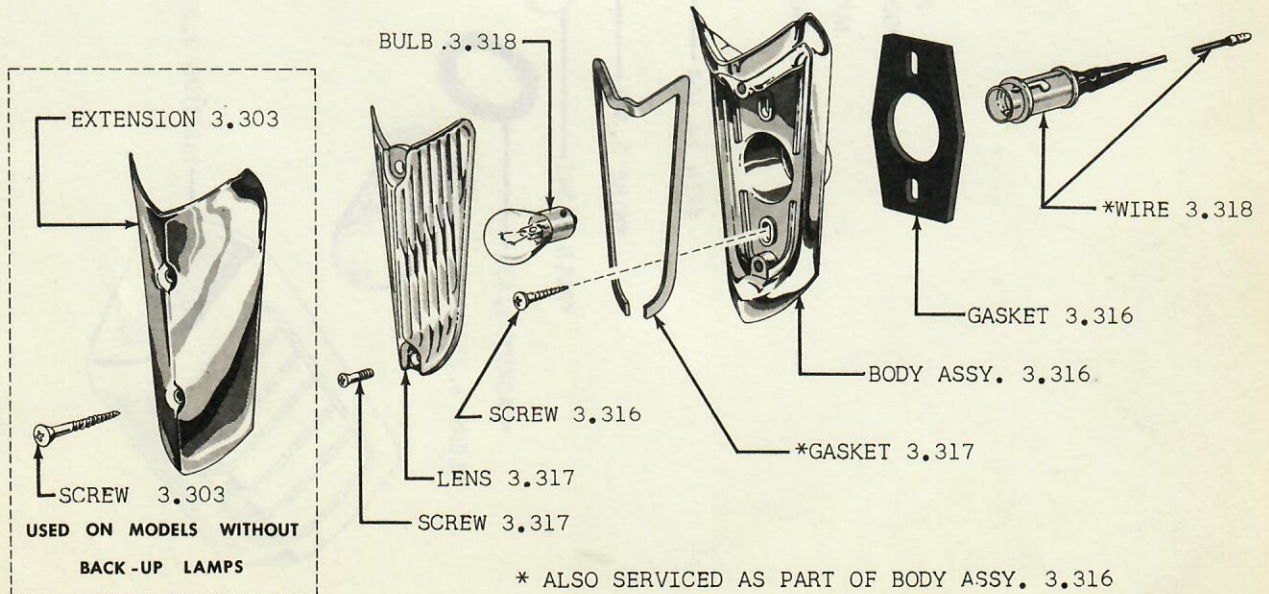

GROUP 3 - FIG. 10H - BACK-UP LAMP 10-20-80

# AMERICAN MOTORS PARTS CATALOG

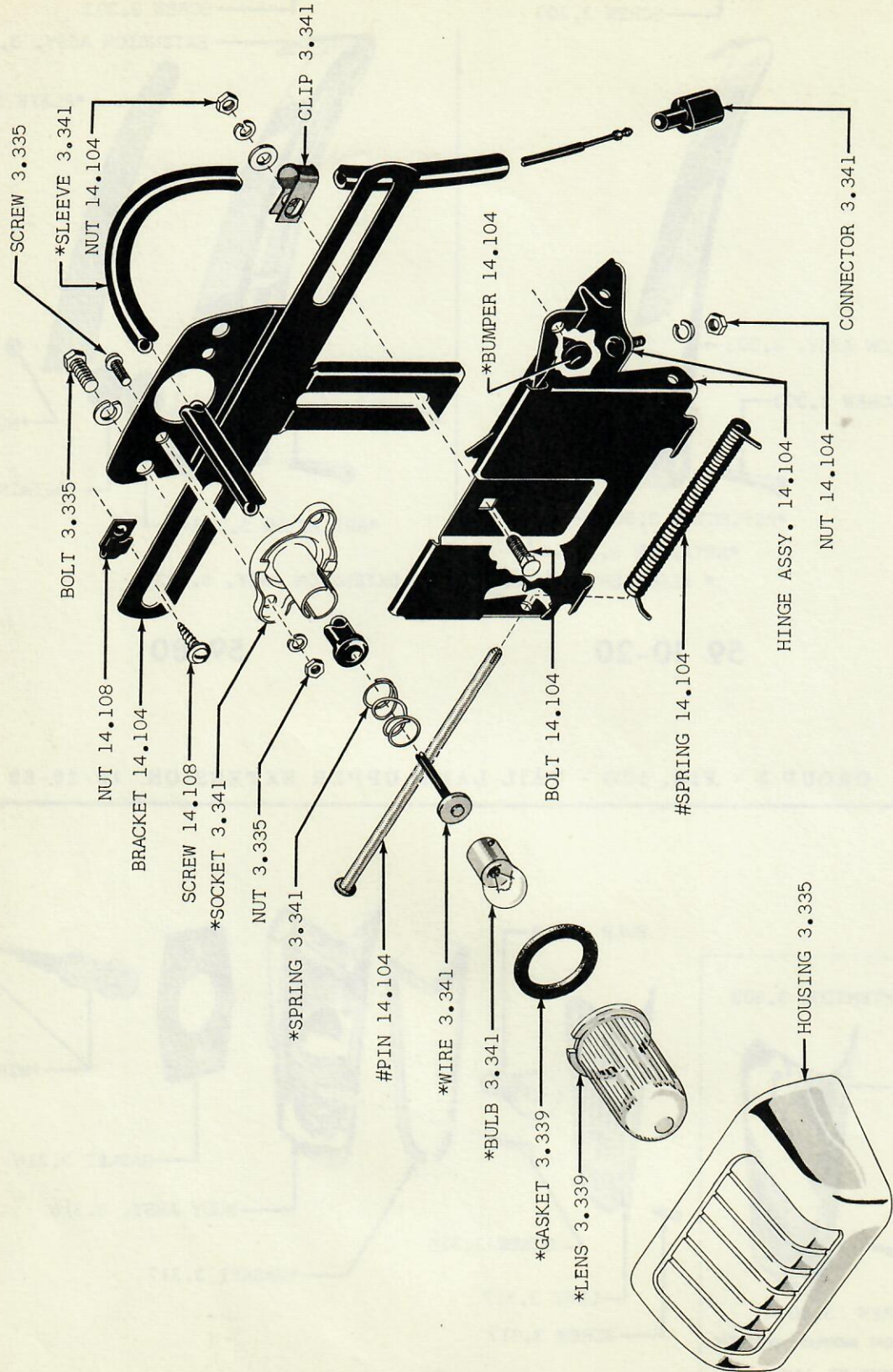

\* ALSO SERVICED AS PART OF LAMP ASSY. 3.335  
 # ALSO SERVICED AS PART OF HINGE ASSY. 14.104

GROUP 3 - FIG. 10i - LICENSE LAMP 01-10-20-80 (WWC)



# AMERICAN MOTORS PARTS CATALOG

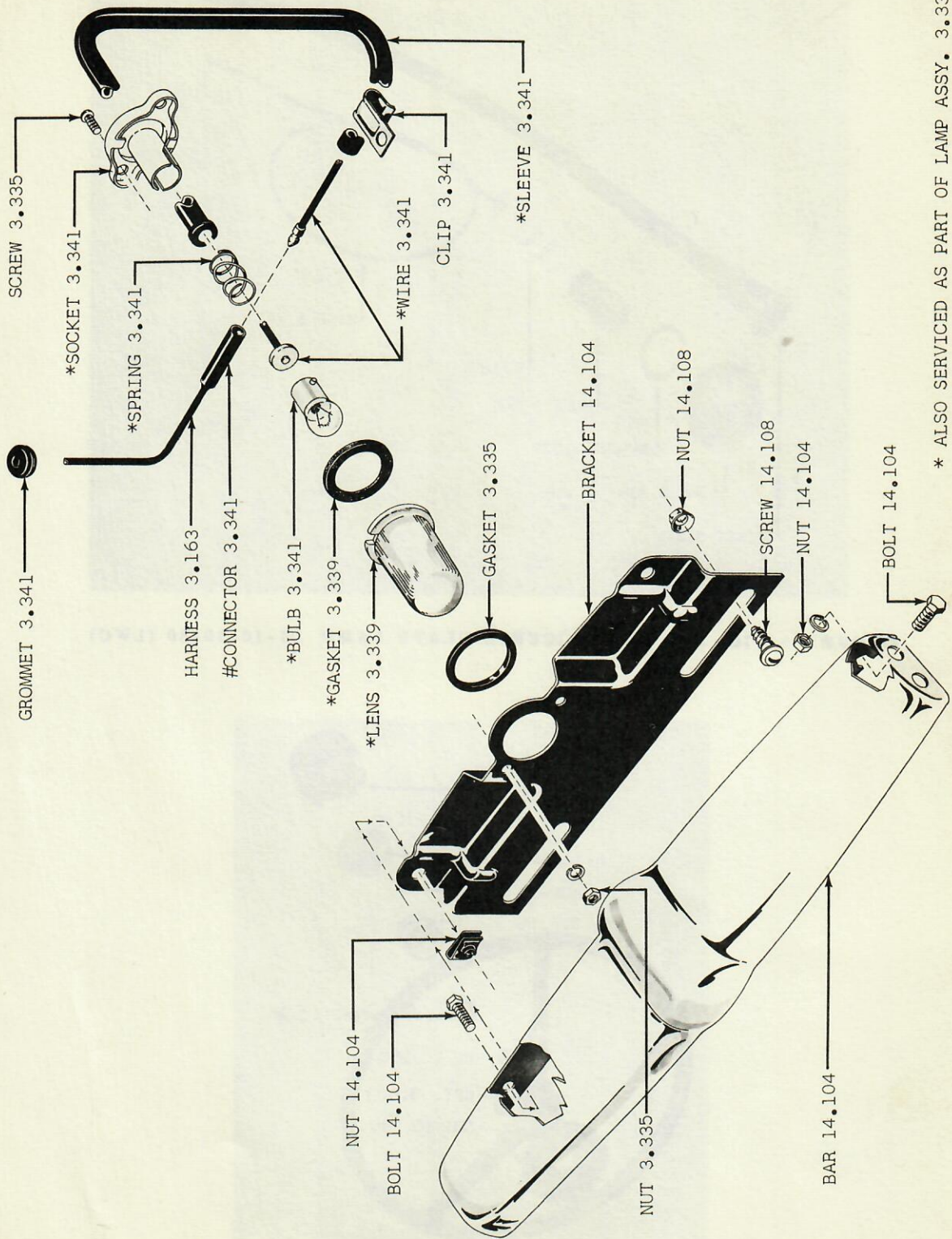

\* ALSO SERVICED AS PART OF LAMP ASSY. 3.335  
# USED ON 01 SERIES ONLY

GROUP 3 - FIG. 10J - LICENSE LAMP 04-18-28-83-88

# AMERICAN MOTORS PARTS CATALOG

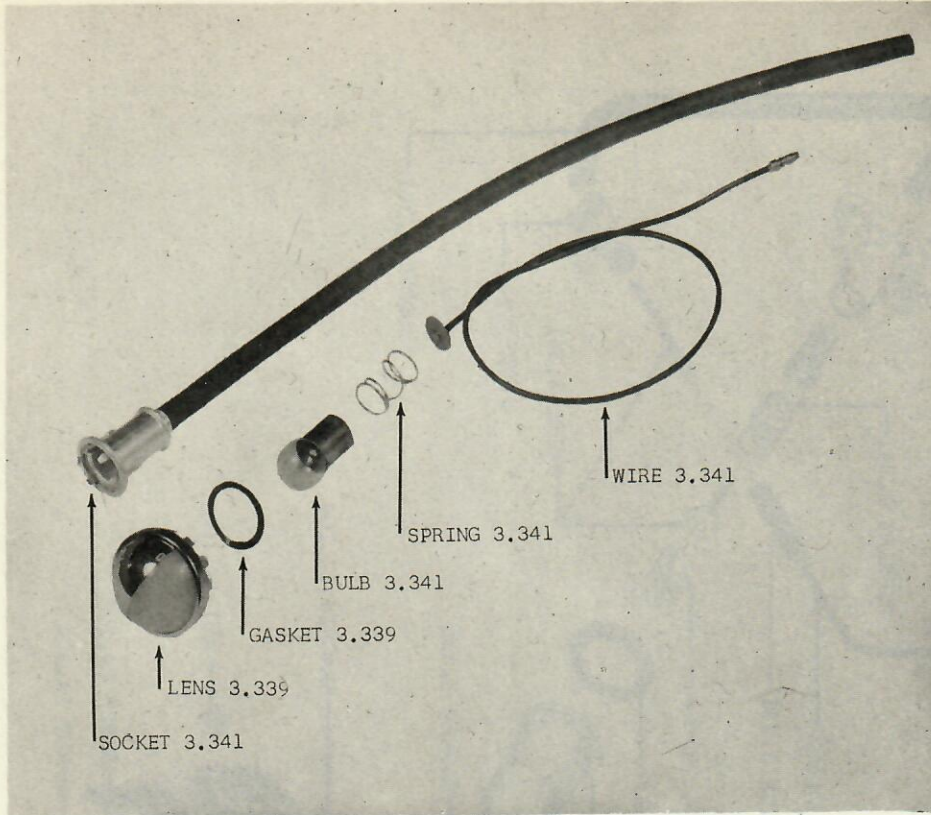

GROUP 3 - FIG. 11 - REAR LICENSE PLATE LAMP 01-10-20-80 (LWC)

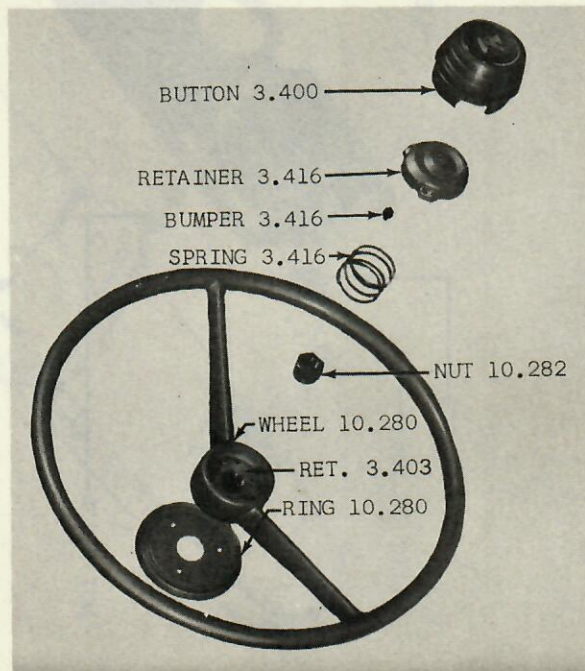

GROUP 3 - FIG. 12 - STEERING WHEEL AND HORN BUTTON 01-10 (DELUXE)

# AMERICAN MOTORS PARTS CATALOG

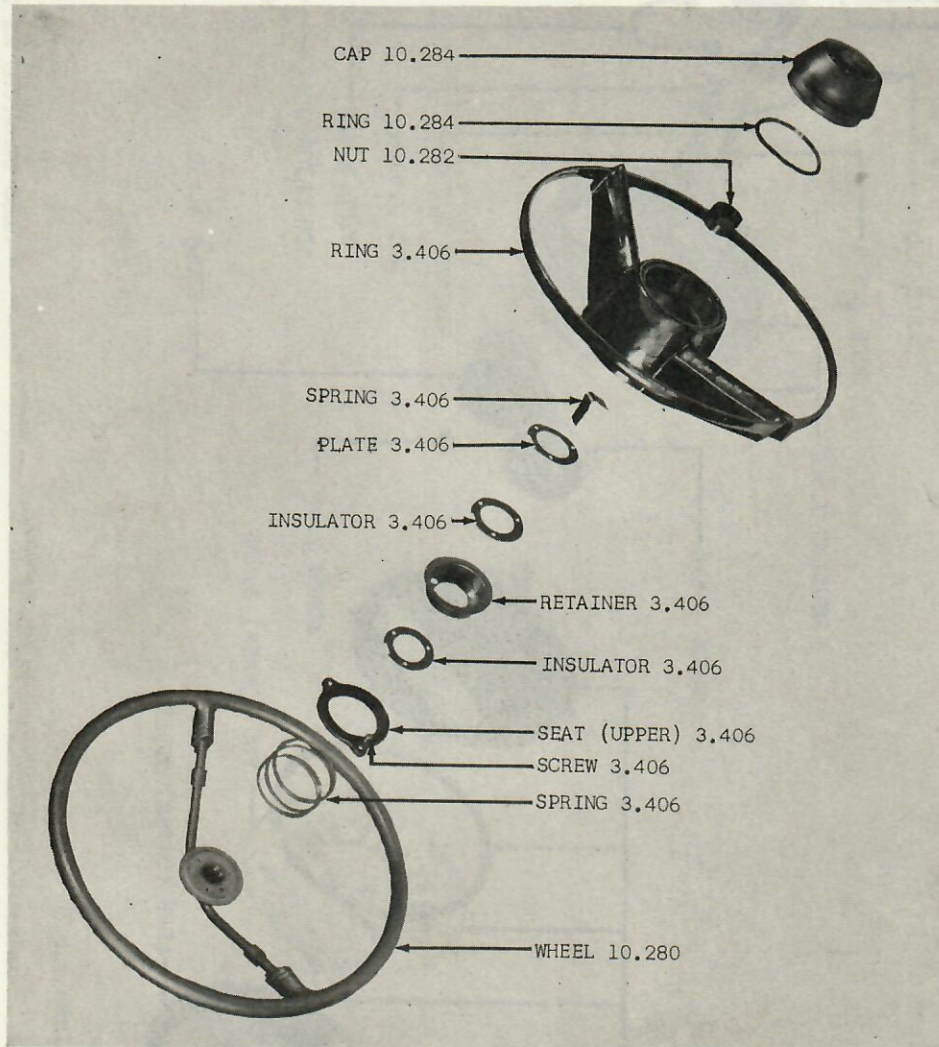

GROUP 3 - FIG. 13 - STEERING WHEEL AND HORN RING 01-10-20-80

# AMERICAN MOTORS PARTS CATALOG

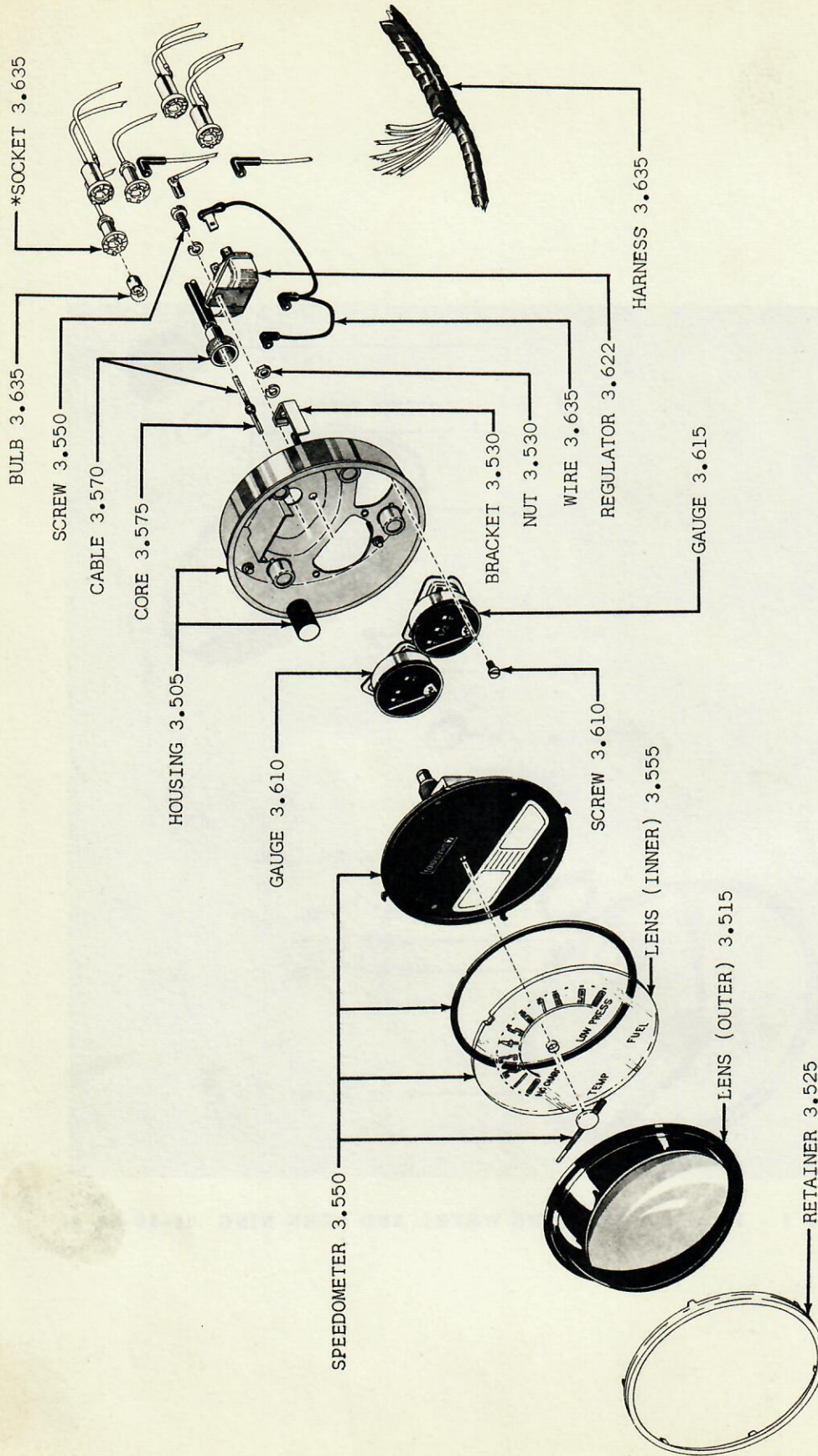

\* ALSO SERVICED AS PART OF HARNESS 3.635

GROUP 3 - FIG. 14 - INSTRUMENT CLUSTER 01

# AMERICAN MOTORS PARTS CATALOG

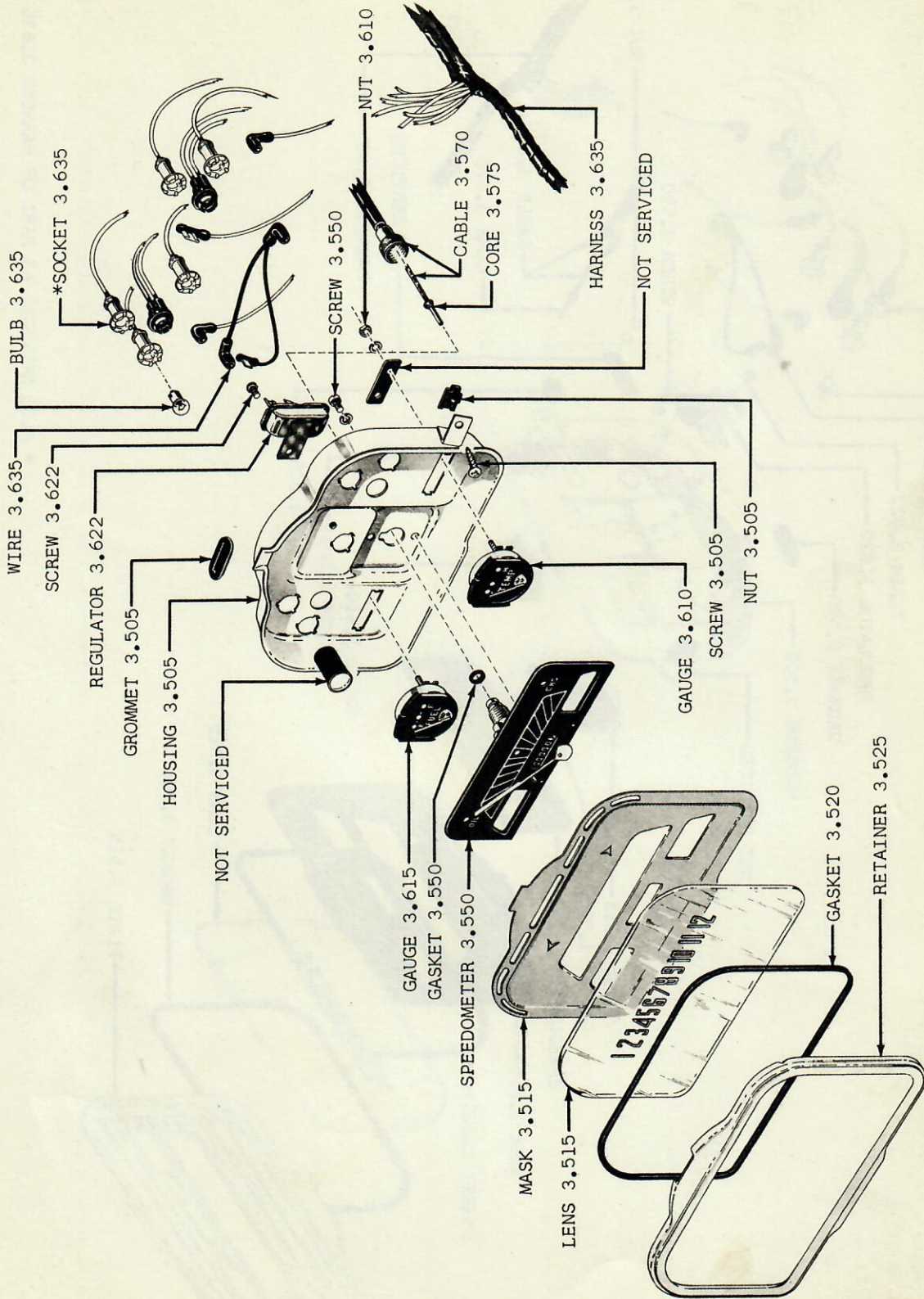

\* ALSO SERVICED AS PART OF HARNESS 3.635

GROUP 3 - FIG. 15 - INSTRUMENT CLUSTER 10-20

# AMERICAN MOTORS PARTS CATALOG

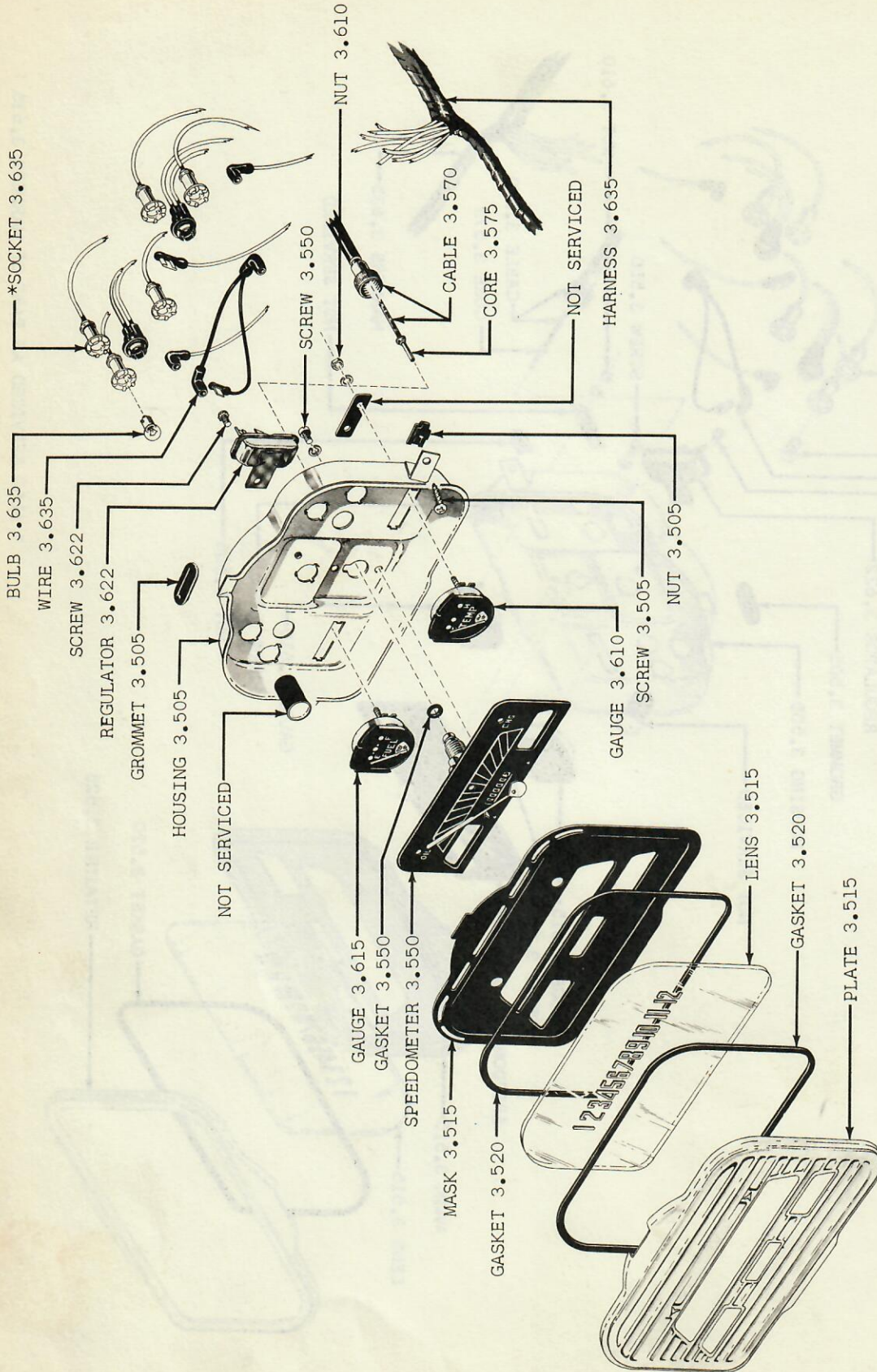

\* ALSO SERVICED AS PART OF HARNESS 3.635

GROUP 3 - FIG. 16 - INSTRUMENT CLUSTER 80

# SPEEDOMETER CABLES

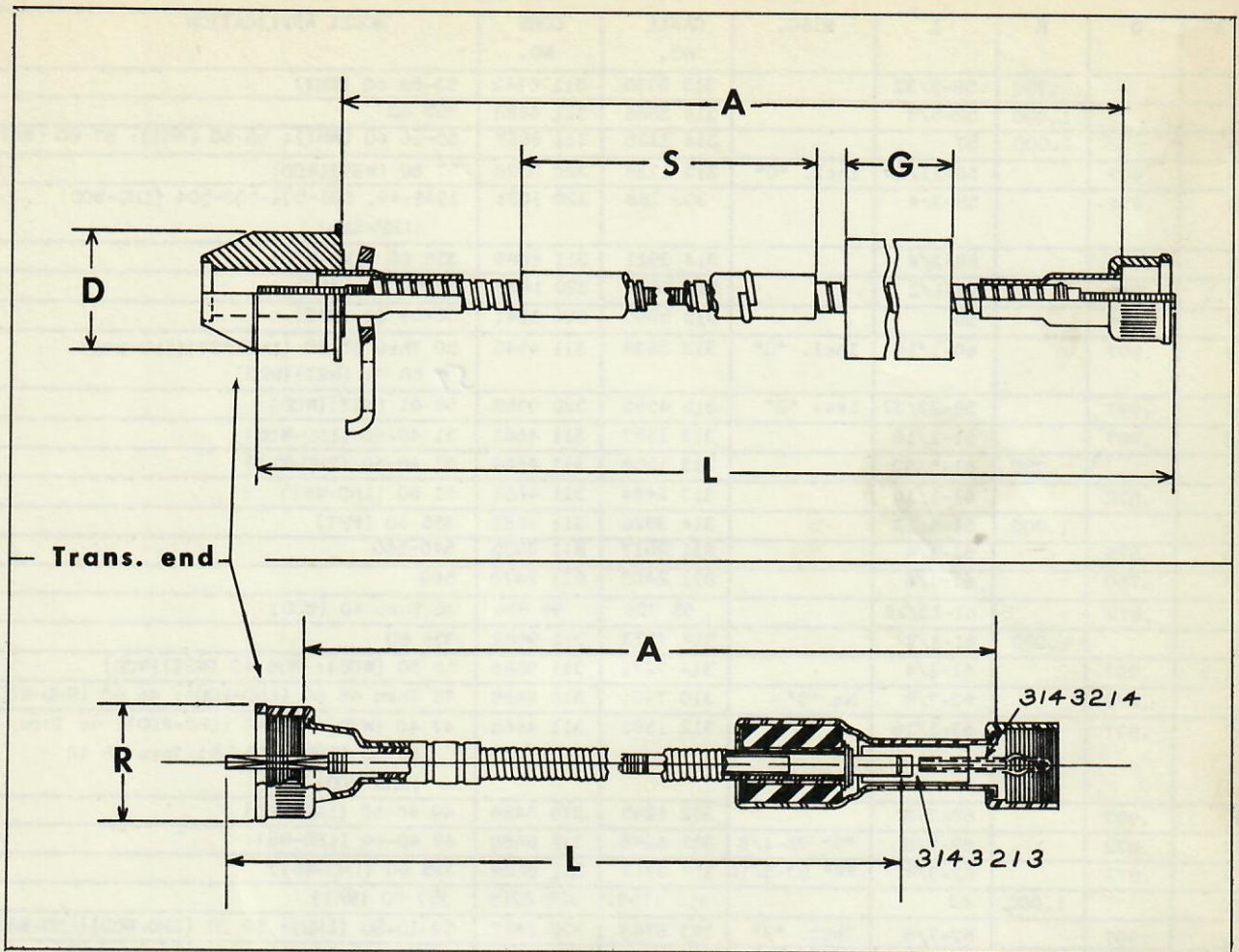

A	D	R	L	MISC.	CABLE NO.	CORE NO.	MODEL APPLICATION
50.5	.997		51-9/16		313 1695	311 4659	51 Thru 56 10 (RHD-WST)
51		.750	52-5/32		313 4237	311 5948	52 Thru 54 40 (WHT); 52-53 60 (WHT); 53 10 (WHT)
52	.872		52-7/8		312 7152	311 3246	49 40 (RHD-WST)
52	.872		53-1/16		313 4231	311 5865	52 Thru 54 40 (WST)
52	.997		53-1/16		313 4232	311 5865	52 Thru 54 40 (WOD)
52	.997		51-3/4		314 3130	311 8860	55-56 40 (WST)(WOD)
53		1.000	52-3/4		314 3132	311 8858	55-56 40 (WHT); 57 80 (WAT)
53		1.000	53-7/16		314 3019	311 8856	55-56 80
55	.872		55-13/16		95 705	96 805	38 Thru 40 (WST)
55	.872		55-7/8	No "S"	310 7900	310 8487	46 40: 47-48 40 (LOD); 46 Thru 48 60 (RHD-LOD)
55	.872		55-7/8	"S" 26-1/8	312 7158	310 8487	49 60 (RHD-WST)
55	.872		56-1/16	"S" 12	313 1556	311 4660	51 40-60 (LHD-WST)
55	.872		56-1/16	"S" 49-3/4	313 4241	311 5864	52 Thru 54 60 (WST)
55	.997		56-1/16		313 4240	311 5864	52 Thru 54 60 (WOD)
55	.872		54-3/4		314 3133	311 8859	55 60 (WST); 56 50 (WST)
55	.997		54-3/4		314 3134	311 8859	55-56 60 (WOD); 56 Thru 58 10 (RHD-WST)
55	.999		55-7/8		314 3981	320 0024	355 40 (LHD-WST)(LHD-WOD)
55	.997		55-7/8	Incl. "G"	343 8746	320 1480	59 10 (RHD-WST)
55 1/2			57-1/4		811 0707	811 1740	540
56		1.000	57-5/32		314 3883	311 8684	355 40 (WHT)
57	.997		57-7/8	Less "G"	312 8532	311 4023	50 10

A	D	R	L	MISC.	CABLE NO.	CORE NO.	MODEL APPLICATION
57		.750	58-5/32		313 8735	311 6742	53-54 60 (WHT)
57		1.000	58-5/8		314 3886	311 8688	355 80
57		1.000	57		314 3135	311 8857	55-56 60 (WHT): 56 50 (WHT): 57 80 (WAT)
57	.997		56-11/64	Incl. "G"	315 1738	320 0220	57 80 (WST)(WOD)
58	.874		58-3/4		302 288	320 1631	1948-49, 501-502-503-504 (LHD-WOD) (LHD-SMD)
58	.999		58-3/4		314 3911	311 8689	355 60 (LHD-WOD)
58.5	.874		59-1/2		315 5090	320 1475	58-59 01 (WAT)
59	.874		60		315 5090	320 1041	58-59 01 (WAT)
59	.997		60-1/16	Incl. "G"	313 0638	311 4545	50 Thru 55 10 (LHD-WST)(LHD-WOD): 57 58 01 (WST)(WOD)
59	.997		58-23/32	Less "G"	315 4595	320 0958	58 01 (WST)(WOD)
60	.997		61-1/16		313 1557	311 4661	51 40-60 (LHD-WOD)
60		.750	61-5/32		313 1558	311 4664	51 40-60 (RHD-WHT)
60	.872		61-1/16		313 2444	311 4661	51 60 (LHD-WST)
60		1.000	61-5/32		314 3926	311 8685	355 60 (WHT)
60	.875		61-1/4		811 2017	811 2035	540-560
60	.750		61-1/4		811 2400	811 2470	560
61	.872		61-13/16		95 706	96 806	38 Thru 40 (WOD)
61		1.000	61-1/2		314 7273	311 9682	356 80
61.5	.997		61-1/4		314 7271	311 9686	56 50 (WOD): 356 40 (WST)(WOD)
62	.872		62-7/8	No "S"	310 7901	310 8488	46 Thru 48 60 (LHD-LOD): 46 60 (RHD-WOD)
62	.997		63-1/16		312 1586	311 4665	47 40 (WOD): 48 40 (LHD-WOD): 46 Thru 48 60 (LHD-WOD): 51 Thru 55 10 (RHD-WOD)
62	.997		62-7/8		312 6245	310 8488	49 40-60 (LHD-WOD)
62	.872		62-7/8	"S" 26-1/8	312 6246	310 8488	49 40-60 (LHD-WST)
62	.872		62-3/4	"S" 53-3/16	314 3912	311 8689	355 60 (LHD-WST)
62		1.000	62		315 1754	320 0219	357 80 (WAT)
62	.997		62-7/8	Incl. "G"	343 8743	320 1477	59 10-80 (LHD): 59 20 (LHD-WOD)(LHD-WAT) 320-1620
63	.874		63-3/4	No "G"	304 707	320 1631	4A-4B-5B-4C-5C (LHD-WOD)(LHD-WHT) (LHD-SMD)
63	.874		63-3/4	Incl. "G"	303 122	320 1631	500,50A (LHD-WOD)(LHD-SMD)
63	.874		63-3/4	"S" 4	304 708	320 1631	5A-6A-7A-8A-6B-7B-8B-7C (LHD-WOD) (LHD-WHT)(LHD-SMD)
63	.999		63-3/4		311 139	320 1631	6D-7D (WAT)
64	.874		64-3/4		302 289	320 1631	1948-49, 501-502-503-504 (LHD-WOD) (LHD-SMD)
64		1.000	64		314 7270	311 9684	356 40-50-60 (WHT)
64	.997		63-3/4		314 6954	311 9687	57-58 10 (LHD-WST)(RHD-WOD)
64	.872		63-3/4		315 2562	311 9687	57-58 20 (LHD-WST): 57 30 (LHD-WST)
64	.872		64-7/8	Incl. "G"	343 8744	320 1478	59 10 (WST-Heavy Duty-Note 3,570-1): 59 20 (LHD-WST) 320-1620
65	.872		65-7/8		310 7278	310 8489	46 60 (LHD-WOD)
65		1.000	66		163 767	320 1625	1946-47 (LHD-LOD)(With Taximeter)
65	.874		65-3/4		162 002	320 1625	1946-47 (LHD-WOD)(Less Taximeter)
65	.997		65-7/8	No "S"	312 1587	310 8489	46 Thru 48 60 (RHD-WOD): 48 40 (RHD-WOD)
65	.997		65-7/8	"S" 26-1/8	312 7157	310 8489	49 40 (RHD-WOD)
65	.997		66-1/16		313 1821	311 4663	51 60 (LHD-WOD)
65		.750	66-5/32		313 8355	311 6554	53 Thru 55 10 (WHT)
66	.874		66-3/4		310 590	320 1625	4D-5D-6D-7D (LHD-WOD)(LHD-WHT) (LHD-WAT)
66	.872		65-3/4		314 7268	311 9683	356 50-60 (WST): 57 20 (LHD-WST)
66	.997		65-3/4		314 7269	311 9683	356 50-60 (WOD): 357 80 (WST)(WOD)
67	.999		67-3/4		308 738	320 1625	1C-2C-1D-2D-3D (LHD-WOD)(LHD-WHT): 4D-5D (WAT)
67	.872		68-1/16		313 2438	311 3792	51 40 (RHD-WST)
68	.872		68-7/8		310 7902	310 8490	41 80: 42 80 (LHD-WOD)
68	.997		68-7/8	Incl. "G"	343 8745	320 1479	59 10 (RHD-WOD)(RHD-WAT): 59 80 (RHD)



A	D	R	L	MISC.	CABLE NO.	CORE NO.	MODEL APPLICATION
68	.997		67-3/4		314 6925	311 9688	56 10 (LHD-WOD): 57 10-20-30 (LHD-WOD): 57 10 (WAT): 58 10 (LHD-WOD)(WAT): 58 20 (LHD-WOD)(LHD-WAT): 58 80
68		1.000	67-7/8		314 6898	311 9685	56 10 (WHT): 57 10 (LHD-WHT): 57 20-30 (WHT)
68		1.000	69-3/16	Incl. "G"	343 8783	320 1481	59 10 (WST) (Note 3.570-2)
70	.872		71-1/16		313 2441	311 3794	51 60 (RHD-WST)
71	.874		71-3/4		162 004	320 1625	1946-47 (LHD-WOD)(Less Taximeter)
71	.874		71-3/4		302 290	320 1625	500,50A (LHD-WOD)(LHD-SMD): 1948-49, 501-502-503-504 (RHD-LOD)
71		1.000	72		304 651	320 1625	1951-52, 7C (WHT)
73	.999		73-3/4	No "S"	308 740	320 1625	1C-2C-1D-2D-3D (LHD-WOD)
73		1.000	74		308 902	320 1625	1C-2C-1D-2D-3D (WHT)
73	.999		73-3/4	No "S"	306 440	320 1625	4B-5B-4C-5C (LHD-WOD) "W"
73	.999		73-3/4	"S" 4	306 442	320 1625	6B-7B-8B-7C (LHD-WOD) "W"
73	.997		73-7/8		312 7151	311 3245	49 60 (RHD-WOD)
74		1.000	75		310 600	320 1624	4D-5D-6D-7D (WHT)
74	.997		75-1/16		312 9065	311 3789	50 40-60 (LHD-WOD)
74	.872		75-1/16		312 9066	311 3789	50 40-60 (LHD-WST)
74		.750	76-21/32		312 8891	311 3795	50 40-60 (LHD-WHT)
75	.872		75-3/4		314 5134	311 9127	355 60 (RHD-WST)
75	.999		75-3/4		314 5135	311 9127	355 40 (RHD-WST)(RHD-WOD): 355 60 (RHD-WOD)
80	.997		81-1/16		313 2439	311 3791	50-51 40 (RHD-WOD)
88	.997		89-1/16	Less "G"	312 9264	311 3793	50-51 60 (RHD-WOD)
88	.997		89-1/16	Incl. "G"	313 2442	311 3793	51 60 (RHD-WOD)

## SPEEDOMETER DRIVEN GEARS

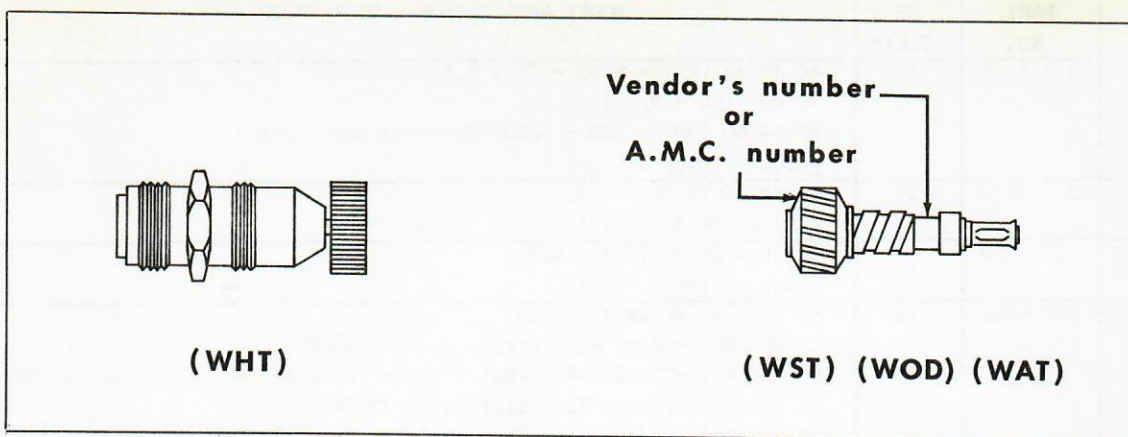

NOTE: This chart does not include Hudson Driven Gears prior to 1955 models.

(Refer Group 6.000 And Group 16.000 For Drive Gear Charts)

VENDOR'S PART NO.	A.M.C. PART NO.	NUMBER OF TEETH	MODEL APPLICATION - GEAR RATIO
417362	313 1863	20	51 60 (WHT - Trans. Serial No. N-51-1 Or Higher) 53-54 10 (WHT - With 15 x 5.90 Tires)
417363	313 1862	22	51 40 (WHT - Trans. Serial No. E-51-1 Or Higher)
418838	313 4960	18	52 60 (WHT)
418845	307 082	18	52 Thru 54 60 (WHT) 355-356 60 (WHT) 355 50 (WHT - 14/43) 56 10 (WHT - 14/43)
420203	314 9785	20	55 10 (WHT) 56 10 (WHT - 13/43) 57 10 (WHT - 13/43 - 15 x 6.40)
420204	315 2293	21	54 40 (WHT) 55 40 (WHT - 12/43 - 15 x 6.70) 55-56 40 (WHT) 56 50 (WHT) 355-356 40 (WHT) 356 50 (WHT - 13/46) 56 10 (WHT - 12/43) 57 20 (WHT - 11/39)
422268	314 3534	19	52-53 40 (WHT) 53-54 10 (WHT - With 15 x 6.40 Tires) 55 10 (WHT)
448015	310 5565	15	46 Thru 48 40 (LOD - 9/37 - 16 x 5.50 And 16 x 6.00)(8/35 - 18 x 6.00) 46 60 (10/41 - Manual Controlled Overdrive) 47 Thru 49 60 (LOD - 10/41) 50 Thru 56 60 (WST - 10/41) 56 50 (WST - 11/45) 356 50 (WST - 11/45) 355-356 60 (WST - 10/41 - 15 x 7.10) 356 60 (WST - 10/41 - 15 x 7.60) 57 Thru 59 20 (WST - 10/41)
448016	310 5566	16	46 Thru 48 40 (LOD - 8/35 - 16 x 6.00) 49 40 (LOD - 9/37) 50 40 (WST - 9/37) 46 60 (9/40 Manual Controlled Overdrive) 47 Thru 49 60 (LOD - 9/40) 50 Thru 56 60 (WST - 9/40) 355-356 60 (WST - 9/40) 57 20 (WST - 9/40)

VENDOR'S PART NO.	A.M.C. PART NO.	NUMBER OF TEETH	MODEL APPLICATION - GEAR RATIO
448017	315 3176	17	46-47 40 (LOD - 8/35 - 16 x 5.50) 48 40 (LOD - 9/37) 53-54 60 (WDJ - LOD - 9/43)(Optional Heavy Duty) 58-59 20 (WST - 9/40)
448132	312 3878	18	47-48 40 (LOD - 8/39) 52 Thru 54 40 (8/39)
448144	313 5150	15	52 Thru 54 40 (WST - 9/37) 58-59 10 (WST - 9/37)
448145	313 5151	16	52 Thru 54 40 (WST - 8/35) 53 10 (WST - Beg. With Serial No. D-150580) 54 06-14-16-17-21-24-27 (WST - Prior To Serial No. D-172751 And DKD-3001) 54 15-25-28 (Prior To Serial No. D-172945) 56 10 (WST - 9/40 Prior To Serial No. D-338187 And Beg. With D-338775) 57 10 (WST - 8/35 Prior To Serial No. D-354549 And Beg. With D-356529) 57 10 (WST - 9/40) 58-59 10 (WST - 8/35)
488155	312 2996	15	46 60 (Governor Controlled Type Overdrive) 47 Thru 56 60 (WOD - 10/41) 55-56 40 (WST - 9/37) 355-356 40 (WST - 9/37) 355-356 60 (WOD - 10/41) 52 Thru 55 10 (WOD) 56 Thru 59 10 (WOD - 9/37) 58-59 01 (WOD - 9/37 With 15 x 6.40) 57 Thru 59 20 (WOD - 10/41) 57 30 (WST - 10/41)(WOD - 10/41) 57 Thru 59 80 (WST - 10/41)(WOD - 10/41) 357 80 (WST - 10/41)(WOD - 10/41)
448156	312 2997	16	46 60 (Governor Controlled Type Overdrive) 47 Thru 56 60 (WOD - 9/40) 55-56 40 (WST - 8/35) 56 50 (WOD - 11/50) 355 40 (WOD - 8/35) 356 40 (WOD - 9/40)(WOD - 11/50) 356 50 (WOD - 11/50) 355 60 (WOD - 9/40) 356 60 (WOD - 11/50) 50 Thru 55 10 (WOD) 56 10 (WST - 8/35 Beg. With Serial No. D-338187 And Prior To D-338775) 56 10 (WOD - 8/35) 56-57 10 (WOD - 9/40) 57 10 (WST - 8/35 Beg. With Serial No. D-354549 And Prior To D-356529) 58-59 01 (WOD - 9/37 With 15 x 5.90) 58-59 10 (WOD - 8/35) 57 20 (WOD - 9/40)
448157	313 0968	17	50 Thru 54 10 (WOD) 58-59 20 (WOD - 9/40) 53-54 60 (WDJ - WOD - 9/43)(Optional Heavy Duty)
448158	312 4369	18	47 Thru 52 40 (WOD - 8/39) 55-56 40 (WST - 8/39)(WOD - 8/39)
448238	312 6562	17	49 40 (LOD - 8/35) 50-51 40 (WST - 8/35)
448240	312 6563	19	49 40 (LOD - 8/39) 50-51 40 (WST - 8/39) 52 10 (WST) 53 10 (WST - Prior To Serial No. D-150580) 54 06-14-16-17-21-24-27 (Beg. With Serial No. D-172751 And DKD-3001) 54 15-25-28 (WST - Beg. With Serial No. D-172945) 55 10 (WST)

VENDOR'S PART NO.	A.M.C. PART NO.	NUMBER OF TEETH	MODEL APPLICATION - GEAR RATIO
448285	313 1168	17	50 10 (LOD - 9/34 Beg. With Serial No. D-44617) 52 10 (WST - 9/34) 53 10 (WST - 9/34 Prior To Serial No. D-150580) 54 06-14-16-17-21-24-27 (WST - 9/34 Beg. With Serial No. D-172751 And DKD-3001) 54 15-25-28 (WST - 9/34 Beg. With Serial No. D-172945) 55 10 (WST - 9/34) 58-59 01 (WST - 9/34)
448288	313 1031	20	50 24 (LOD - 8/35) 51-52 10 (WST) 53 10 (WST - Prior To Serial No. D-150580) 54 06-14-16-17-21-24-27 (WST - Beg. With Serial No. D-172751 And DKD-3001) 54 15-25-28 (WST - Beg. With Serial No. D-172945)
448293	312 8698	17	50 10 (LOD - Prior To Serial No. D-44617)
448368	313 6259	21	52 Thru 54 40 (WOD - 8/39)
448410	313 8677	14	53 10 (WST - Beg. With Serial No. D-150580) 54 06-14-16-17-21-24-27 (WST - Prior To Serial No. D-172751 And DKD-3001) 54 15-25-28 (WST - Prior To Serial No. D-172945) 56 10 (WST - 9/34 Prior To Serial No. D-338187 And Beg. With D-338775) 57 10 (WST - 9/34 Prior To Serial No. D-354549 And Beg. With D-356529) 58-59 10 (WST - 9/34) 57-357 80 (WHT - 13/41)
448530	315 0562	20	57 Thru 59 10 (WAT - 13/43 - 15 x 6.40)
448539	315 2338	14	56 10 (WST - 9/34 Beg. With Serial No. D-338187 And Prior To D-338775): 57 10 (WST - 9/34 Beg. With Serial No. D-354549 And Prior To D-356529)
448540	315 2690	19	57 Thru 59 10 (WAT - 13/43 - 15 x 6.70) 58-59 20 (WAT - 13/41) 58-59 80 (WAT - 13/41)
448554	315 2969	21	57 Thru 59 20 (WAT - 11/39)
448562	315 3728	22	57 Thru 59 10 (WAT - 9/34)
448600	315 5091	20	58-59 01 (WAT - 13/43)
448601	315 5345	14	58-59 01 (WOD - 9/34 - 15 x 5.90)
448602	315 5346	15	58-59 01 (WST - 13/43)
448629	315 5863	14	59 10 (WST - 9/34 Note 3.570 - 2)
1315022	312 8798	18	50 60 (WHT) 51 60 (WHT - Trans. Serial No. N-50-1 Or Higher)
1315447	313 0445	20	50 40 (WHT) 51 40 (WHT - Trans. Serial No. E-50-1 Or Higher)
PT 1038	811 2360	28	560
---	811 0469	8	540
---	811 1863	13	540 (9/41): 560
---	315 7031	13	(NYLON) 59 80 (WST - 11/39)(WOD - 11/39)
---	315 7167	14	(NYLON) 59 10 (WST - 9/34 - Note 3.570-1 And Note 3.570-2)
---	315 6206	17	(NYLON) 59 80 (WAT - 15/41)
---	315 0348	18	(FIBRE GEAR) 55-56 60 (WHT) (FIBRE GEAR) 57 30 (WHT - 13/41)
---	645 0318	18	(NYLON) 55-56 80 (13/41) (NYLON) 355-356 80 (13/41)
---	315 0711	19	(FIBRE GEAR) 57 10 (LHD - WHT - 13/43 - 15 x 6.70)
---	645 0320	20	(NYLON) 55 80 (11/39) (NYLON) 355 80 (11/39)